

# KAILUA TOWN

151 Hekili St, Kailua, HI, 96734



## PROPERTY

Kailua Town is a collection of shopping centers with some light industrial space in the commercial core of the Kailua beach community on the windward side of Oahu. Known for picturesque beaches, great shopping and restaurants, Kailua is a tight knit community with a laid-back vibe, appealing to residents and visitors. Kailua boasts strong resident demographics of above-average household and discretionary income and is a destination for national and international visitors. Kailua Town's diverse mix of national tenants and unique small businesses add to the charm of this beach-side community.

## CENTER SIZE

395,200 SF

### 2021 DEMOGRAPHICS

	1-Mile	3-Mile	5-Mile
Estimated Population	16,657	47,185	95,411
2021 Projected Population	16,657	47,185	95,411
Total Households	5,710	15,350	29,048
Average Household Income	\$137,424	\$154,289	\$137,554
Daytime Population	15,767	42,459	84,773
Median Age	43	44	39
Bachelor Degree or Higher	48%	50%	42%



ALEXANDER & BALDWIN

822 Bishop Street, Honolulu, HI 96813 | [www.alexanderbaldwin.com](http://www.alexanderbaldwin.com)

Leasing: **Matt Schull (S)** (808) 525-6662 | [mschull@abhi.com](mailto:mschull@abhi.com)



# KAILUA TOWN

151 Hekili St, Kailua, HI, 96734

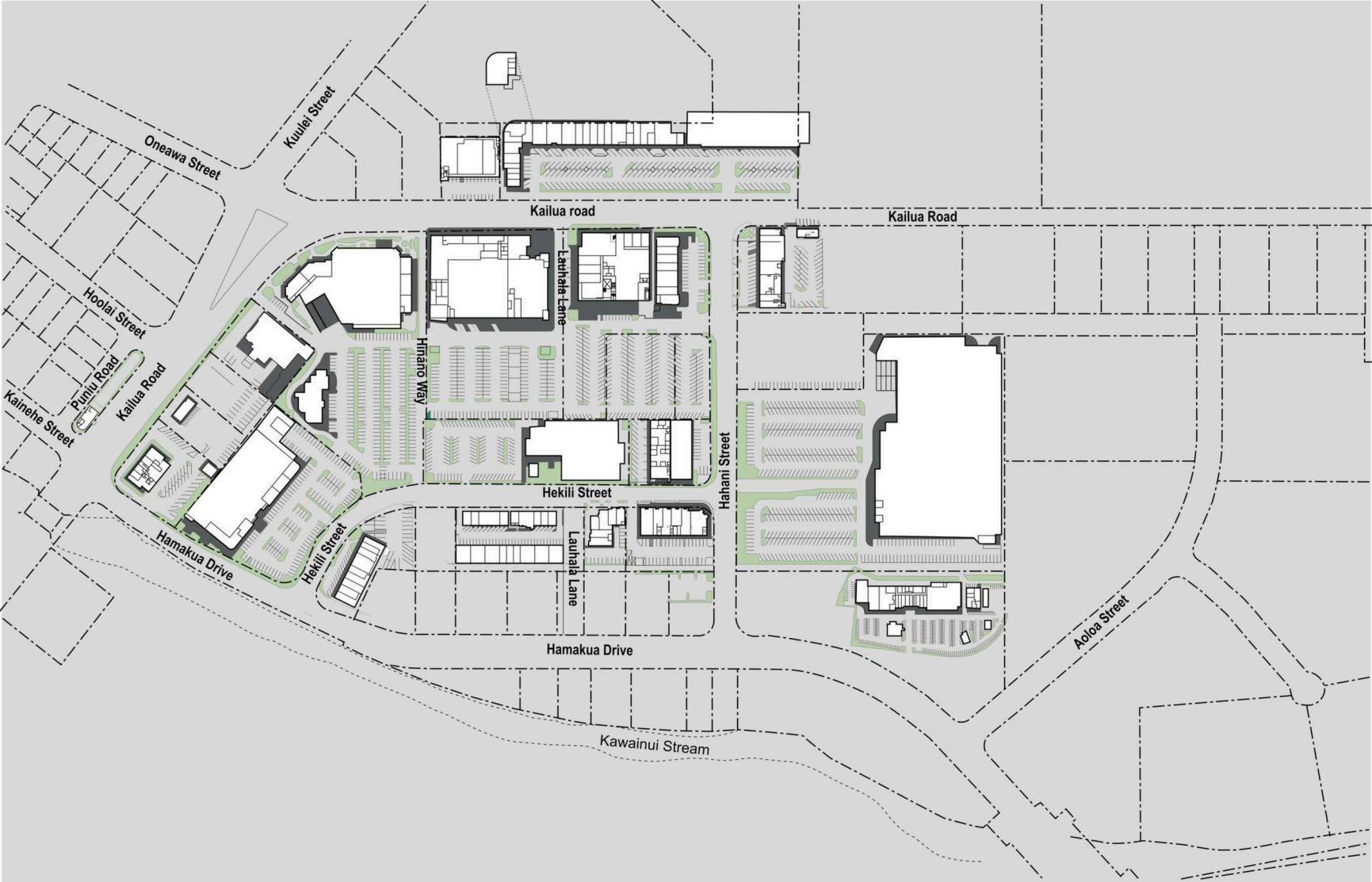

# KAILUA TOWN

151 Hekili St, Kailua, HI, 96734

## AVAILABLE SPACES

SPACE	SF
No Availabilities	

All information is subject to change without notice. Dimensions, configurations, and frontages are approximate and any measurements are estimates. No promise is made that the spaces, common areas, amenities, landscaping, or features depicted are or will be built, or if built will be as shown. Landlord makes no representations about specific tenants or where they may operate. Unless Landlord signs a binding lease for a specific space, you do not have a right to lease any space. No content from these pages may be copied, republished, or distributed in any way without Landlord's written consent. Despite Landlord's efforts to provide accurate information, it is not possible to ensure it is always up to date, and Landlord assumes no responsibility for any actions taken in reliance on this information.



# KAILUA TOWN

151 Hekili St, Kailua, HI, 96734

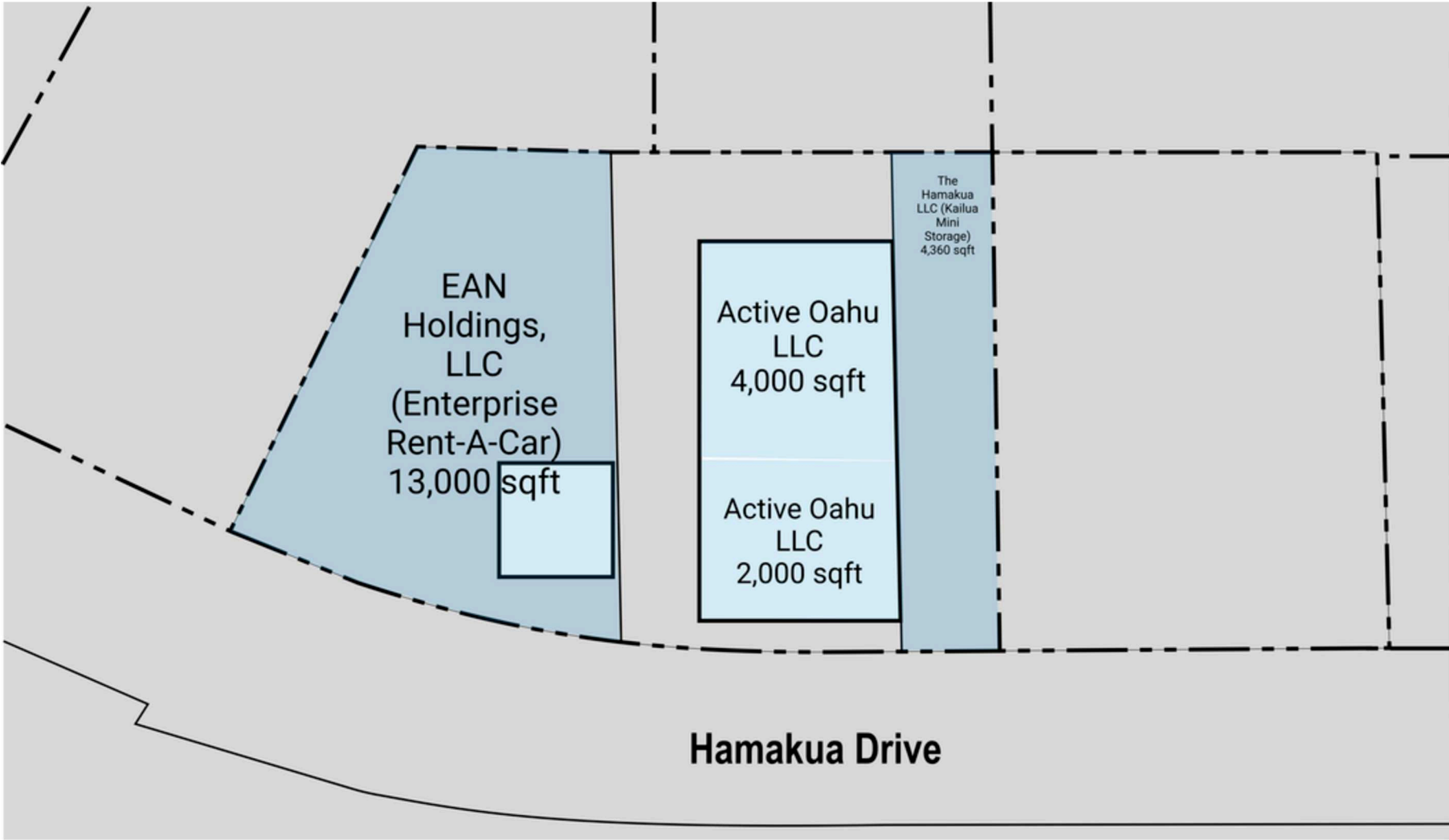

# KAILUA TOWN

151 Hekili St, Kailua, HI, 96734

## AVAILABLE SPACES

SPACE	SF
No Availabilities	

All information is subject to change without notice. Dimensions, configurations, and frontages are approximate and any measurements are estimates. No promise is made that the spaces, common areas, amenities, landscaping, or features depicted are or will be built, or if built will be as shown. Landlord makes no representations about specific tenants or where they may operate. Unless Landlord signs a binding lease for a specific space, you do not have a right to lease any space. No content from these pages may be copied, republished, or distributed in any way without Landlord's written consent. Despite Landlord's efforts to provide accurate information, it is not possible to ensure it is always up to date, and Landlord assumes no responsibility for any actions taken in reliance on this information.



# KAILUA TOWN

151 Hekili St, Kailua, HI, 96734

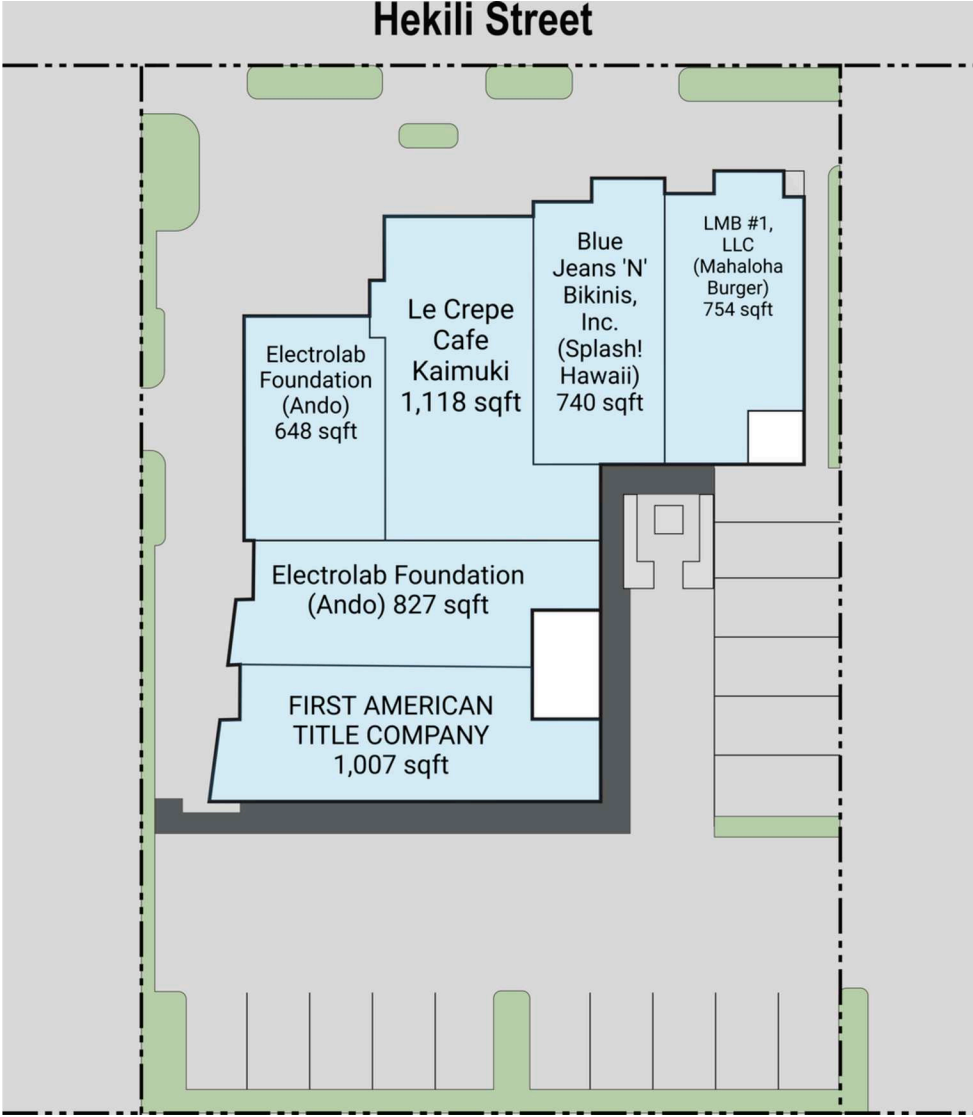

ALEXANDER & BALDWIN

Leasing: **Matt Schull (S)** (808) 525-6662 | [mshull@abhi.com](mailto:mshull@abhi.com)

822 Bishop Street, Honolulu, HI 96813 | [www.alexanderbaldwin.com](http://www.alexanderbaldwin.com)



# KAILUA TOWN

151 Hekili St, Kailua, HI, 96734

## AVAILABLE SPACES

SPACE	SF
No Availabilities	

All information is subject to change without notice. Dimensions, configurations, and frontages are approximate and any measurements are estimates. No promise is made that the spaces, common areas, amenities, landscaping, or features depicted are or will be built, or if built will be as shown. Landlord makes no representations about specific tenants or where they may operate. Unless Landlord signs a binding lease for a specific space, you do not have a right to lease any space. No content from these pages may be copied, republished, or distributed in any way without Landlord's written consent. Despite Landlord's efforts to provide accurate information, it is not possible to ensure it is always up to date, and Landlord assumes no responsibility for any actions taken in reliance on this information.



# KAILUA TOWN

151 Hekili St, Kailua, HI, 96734

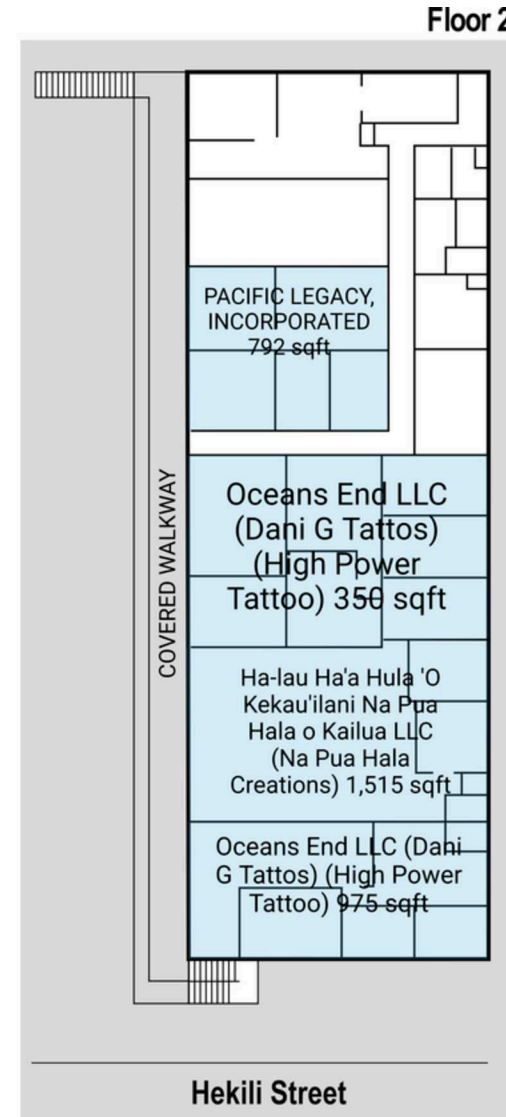
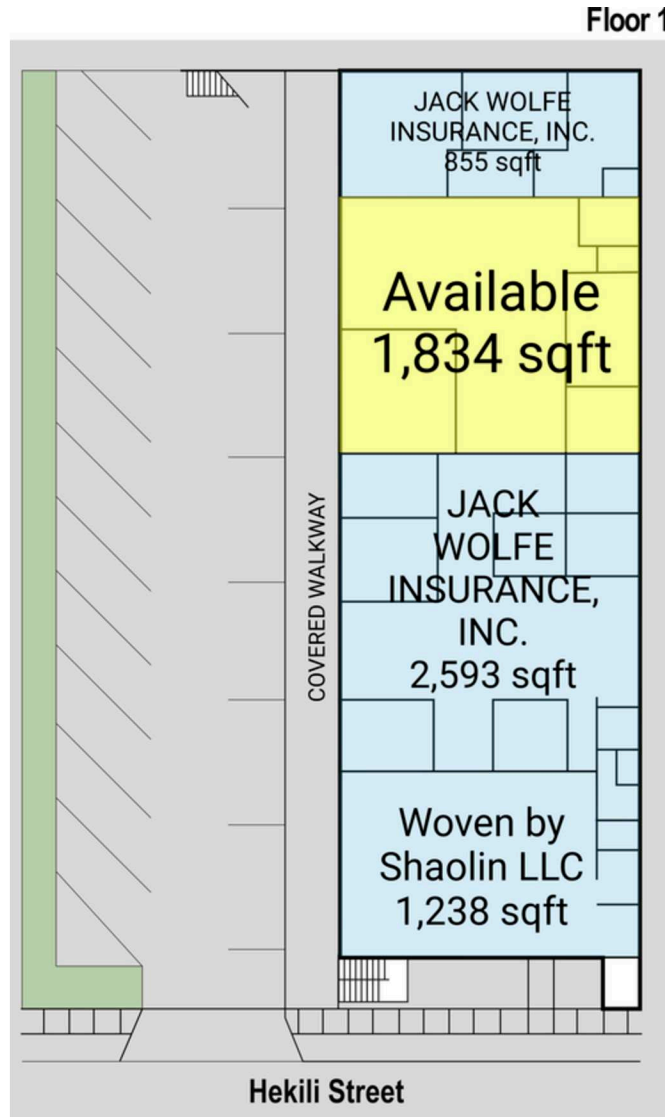

ALEXANDER & BALDWIN

822 Bishop Street, Honolulu, HI 96813 | [www.alexanderbaldwin.com](http://www.alexanderbaldwin.com)

Leasing: **Matt Schull (S)** (808) 525-6662 | [mshull@abhi.com](mailto:mshull@abhi.com)





# KAILUA TOWN

151 Hekili St, Kailua, HI, 96734

## AVAILABLE SPACES

SPACE	SF
104	1,834 SF

All information is subject to change without notice. Dimensions, configurations, and frontages are approximate and any measurements are estimates. No promise is made that the spaces, common areas, amenities, landscaping, or features depicted are or will be built, or if built will be as shown. Landlord makes no representations about specific tenants or where they may operate. Unless Landlord signs a binding lease for a specific space, you do not have a right to lease any space. No content from these pages may be copied, republished, or distributed in any way without Landlord's written consent. Despite Landlord's efforts to provide accurate information, it is not possible to ensure it is always up to date, and Landlord assumes no responsibility for any actions taken in reliance on this information.



ALEXANDER & BALDWIN

822 Bishop Street, Honolulu, HI 96813 | [www.alexanderbaldwin.com](http://www.alexanderbaldwin.com)

Leasing: **Matt Schull (S)** (808) 525-6662 | [mschull@abhi.com](mailto:mschull@abhi.com)



# KAILUA TOWN

151 Hekili St, Kailua, HI, 96734

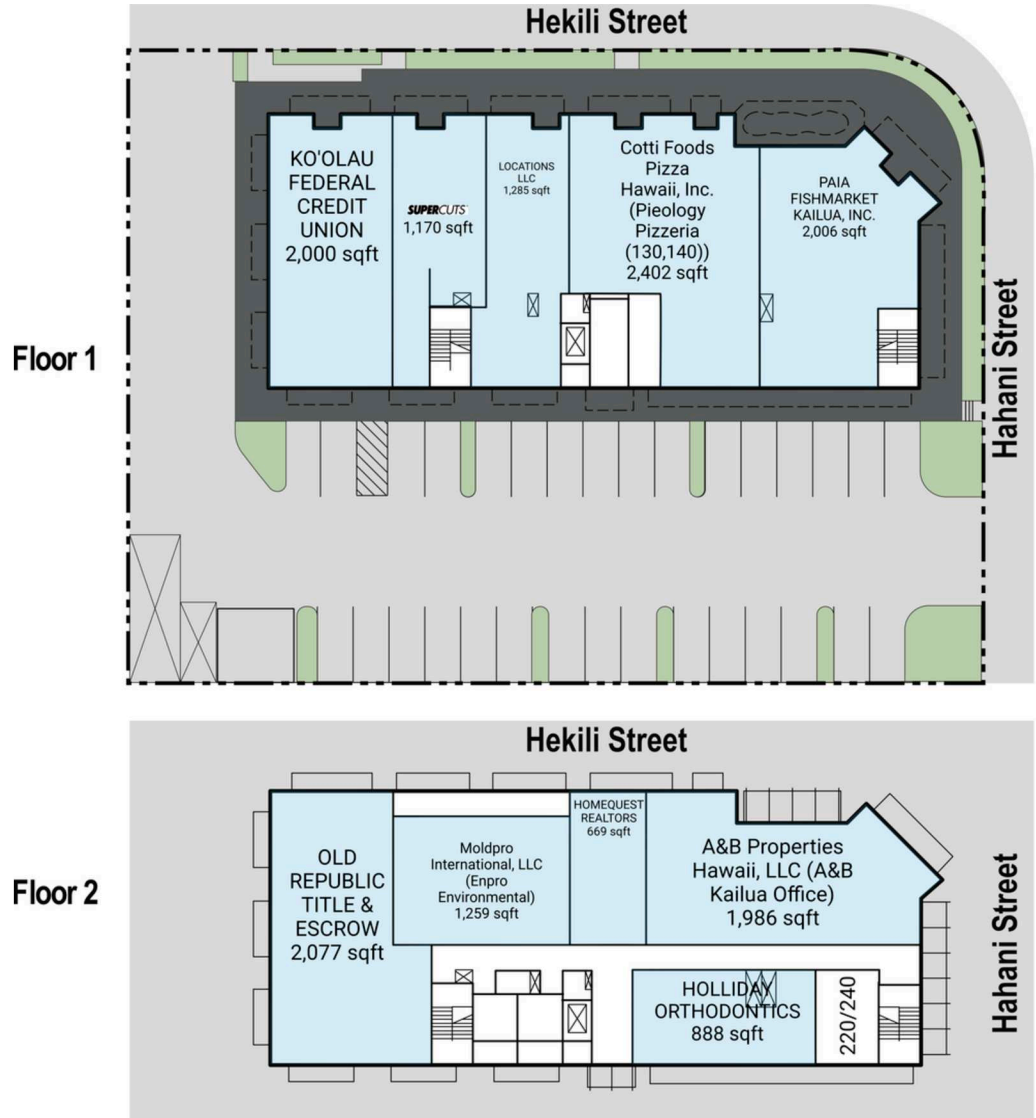

ALEXANDER & BALDWIN

822 Bishop Street, Honolulu, HI 96813 | [www.alexanderbaldwin.com](http://www.alexanderbaldwin.com)

Leasing: **Matt Schull (S)** (808) 525-6662 | [mschull@abhi.com](mailto:mschull@abhi.com)



# KAILUA TOWN

151 Hekili St, Kailua, HI, 96734

## AVAILABLE SPACES

SPACE	SF
No Availabilities	

All information is subject to change without notice. Dimensions, configurations, and frontages are approximate and any measurements are estimates. No promise is made that the spaces, common areas, amenities, landscaping, or features depicted are or will be built, or if built will be as shown. Landlord makes no representations about specific tenants or where they may operate. Unless Landlord signs a binding lease for a specific space, you do not have a right to lease any space. No content from these pages may be copied, republished, or distributed in any way without Landlord's written consent. Despite Landlord's efforts to provide accurate information, it is not possible to ensure it is always up to date, and Landlord assumes no responsibility for any actions taken in reliance on this information.



# KAILUA TOWN

151 Hekili St, Kailua, HI, 96734

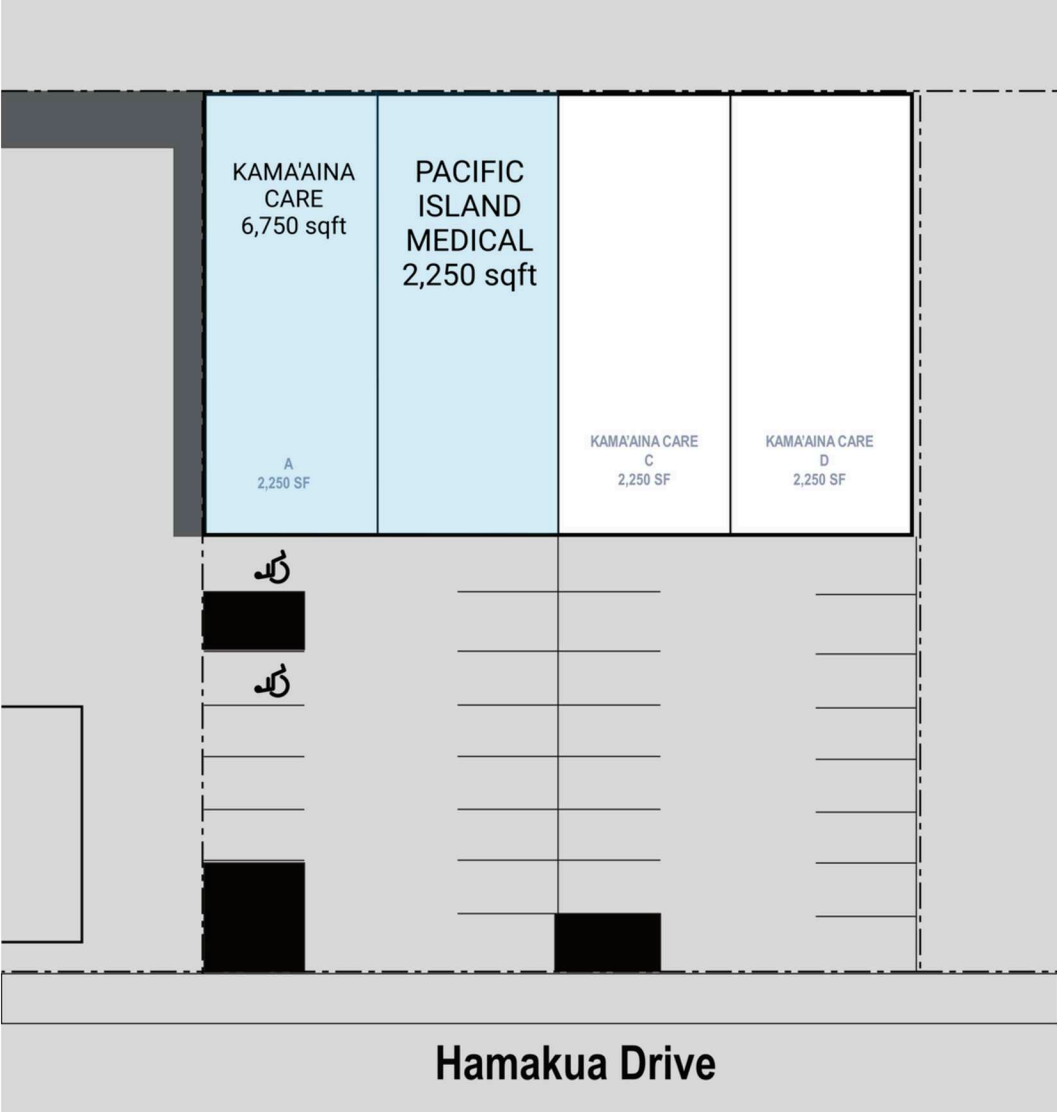

# KAILUA TOWN

151 Hekili St, Kailua, HI, 96734

## AVAILABLE SPACES

SPACE	SF
No Availabilities	

All information is subject to change without notice. Dimensions, configurations, and frontages are approximate and any measurements are estimates. No promise is made that the spaces, common areas, amenities, landscaping, or features depicted are or will be built, or if built will be as shown. Landlord makes no representations about specific tenants or where they may operate. Unless Landlord signs a binding lease for a specific space, you do not have a right to lease any space. No content from these pages may be copied, republished, or distributed in any way without Landlord's written consent. Despite Landlord's efforts to provide accurate information, it is not possible to ensure it is always up to date, and Landlord assumes no responsibility for any actions taken in reliance on this information.



# KAILUA TOWN

151 Hekili St, Kailua, HI, 96734

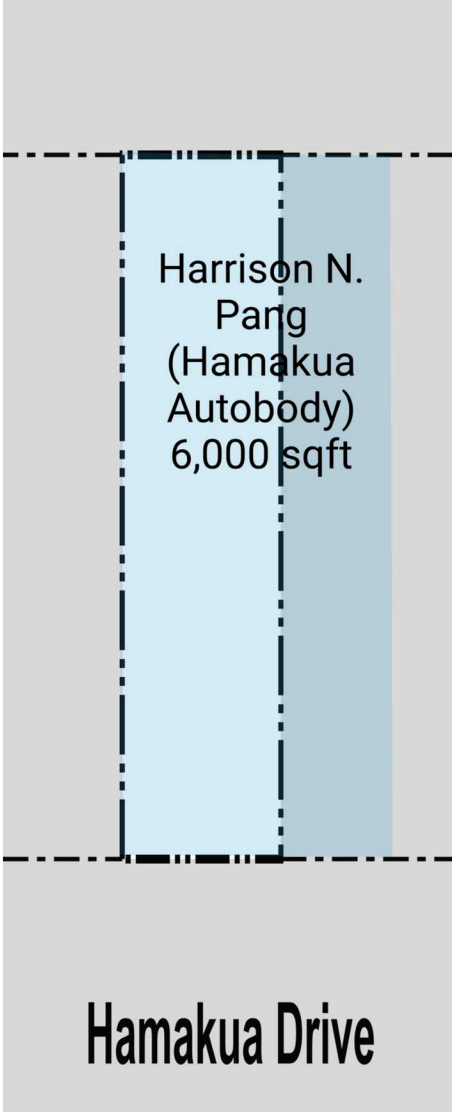

ALEXANDER & BALDWIN

822 Bishop Street, Honolulu, HI 96813 | [www.alexanderbaldwin.com](http://www.alexanderbaldwin.com)

Leasing: **Matt Schull (S)** (808) 525-6662 | [mSchull@abhi.com](mailto:mSchull@abhi.com)



# KAILUA TOWN

151 Hekili St, Kailua, HI, 96734

## AVAILABLE SPACES

SPACE	SF
No Availabilities	

All information is subject to change without notice. Dimensions, configurations, and frontages are approximate and any measurements are estimates. No promise is made that the spaces, common areas, amenities, landscaping, or features depicted are or will be built, or if built will be as shown. Landlord makes no representations about specific tenants or where they may operate. Unless Landlord signs a binding lease for a specific space, you do not have a right to lease any space. No content from these pages may be copied, republished, or distributed in any way without Landlord's written consent. Despite Landlord's efforts to provide accurate information, it is not possible to ensure it is always up to date, and Landlord assumes no responsibility for any actions taken in reliance on this information.



# KAILUA TOWN

151 Hekili St, Kailua, HI, 96734

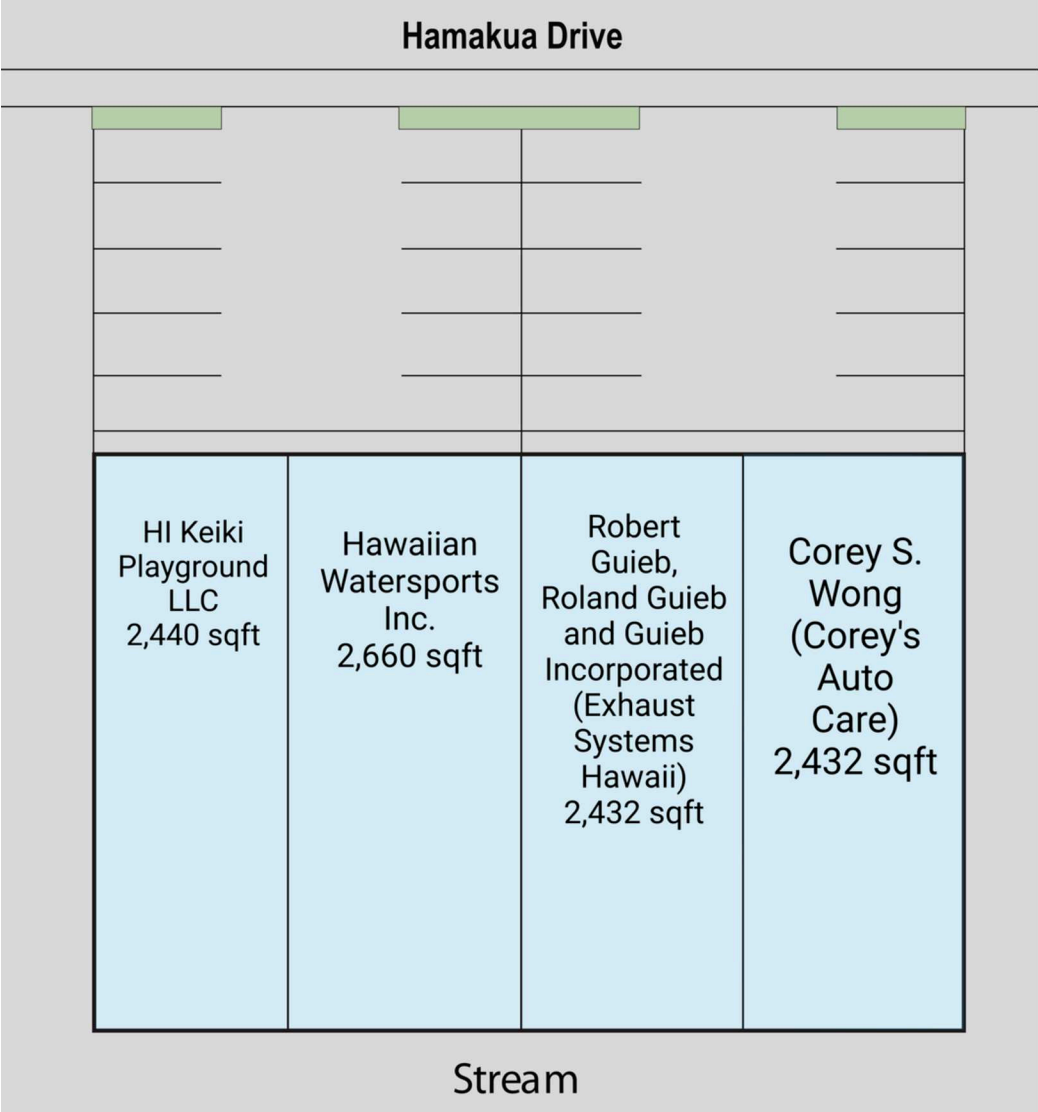

ALEXANDER & BALDWIN

822 Bishop Street, Honolulu, HI 96813 | [www.alexanderbaldwin.com](http://www.alexanderbaldwin.com)

Leasing: **Matt Schull (S)** (808) 525-6662 | [mSchull@abhi.com](mailto:mSchull@abhi.com)





# KAILUA TOWN

151 Hekili St, Kailua, HI, 96734

## AVAILABLE SPACES

SPACE	SF
No Availabilities	

All information is subject to change without notice. Dimensions, configurations, and frontages are approximate and any measurements are estimates. No promise is made that the spaces, common areas, amenities, landscaping, or features depicted are or will be built, or if built will be as shown. Landlord makes no representations about specific tenants or where they may operate. Unless Landlord signs a binding lease for a specific space, you do not have a right to lease any space. No content from these pages may be copied, republished, or distributed in any way without Landlord's written consent. Despite Landlord's efforts to provide accurate information, it is not possible to ensure it is always up to date, and Landlord assumes no responsibility for any actions taken in reliance on this information.



# KAILUA TOWN

151 Hekili St, Kailua, HI, 96734

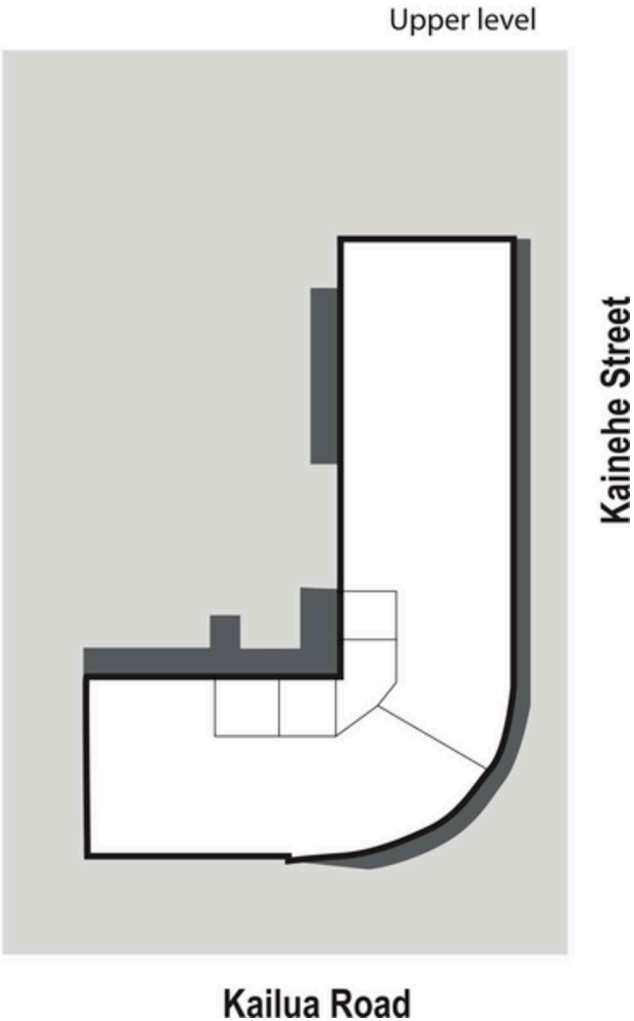
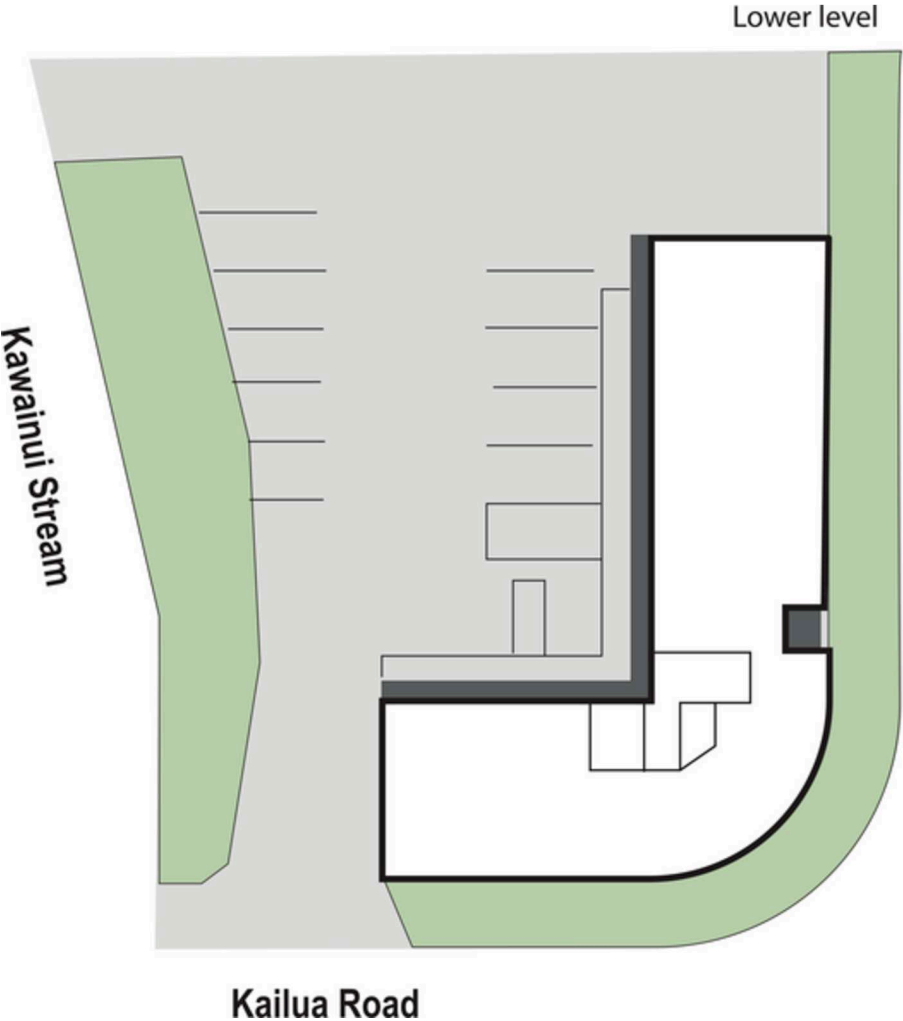

# KAILUA TOWN

151 Hekili St, Kailua, HI, 96734

## AVAILABLE SPACES

SPACE	SF
No Availabilities	

All information is subject to change without notice. Dimensions, configurations, and frontages are approximate and any measurements are estimates. No promise is made that the spaces, common areas, amenities, landscaping, or features depicted are or will be built, or if built will be as shown. Landlord makes no representations about specific tenants or where they may operate. Unless Landlord signs a binding lease for a specific space, you do not have a right to lease any space. No content from these pages may be copied, republished, or distributed in any way without Landlord's written consent. Despite Landlord's efforts to provide accurate information, it is not possible to ensure it is always up to date, and Landlord assumes no responsibility for any actions taken in reliance on this information.



ALEXANDER & BALDWIN

822 Bishop Street, Honolulu, HI 96813 | [www.alexanderbaldwin.com](http://www.alexanderbaldwin.com)

Leasing: **Matt Schull (S)** (808) 525-6662 | [mschull@abhi.com](mailto:mschull@abhi.com)



# KAILUA TOWN

151 Hekili St, Kailua, HI, 96734

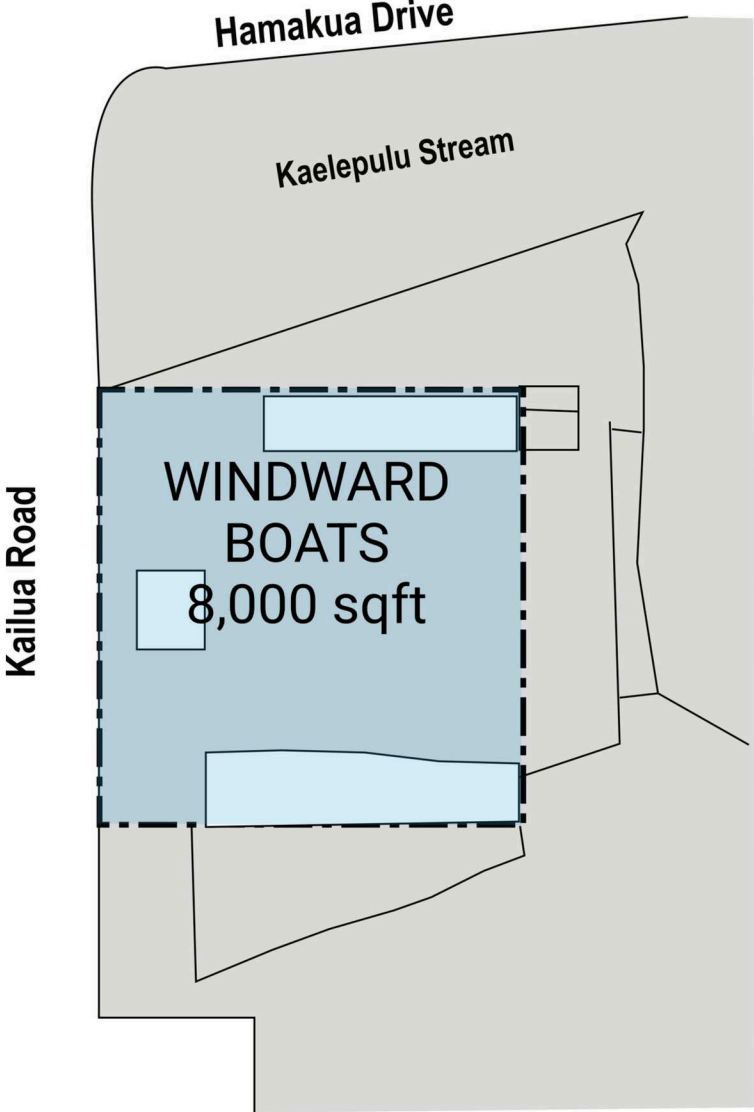

ALEXANDER & BALDWIN

822 Bishop Street, Honolulu, HI 96813 | [www.alexanderbaldwin.com](http://www.alexanderbaldwin.com)

Leasing: **Matt Schull (S)** (808) 525-6662 | [mschull@abhi.com](mailto:mschull@abhi.com)



# KAILUA TOWN

151 Hekili St, Kailua, HI, 96734

## AVAILABLE SPACES

SPACE	SF
No Availabilities	

All information is subject to change without notice. Dimensions, configurations, and frontages are approximate and any measurements are estimates. No promise is made that the spaces, common areas, amenities, landscaping, or features depicted are or will be built, or if built will be as shown. Landlord makes no representations about specific tenants or where they may operate. Unless Landlord signs a binding lease for a specific space, you do not have a right to lease any space. No content from these pages may be copied, republished, or distributed in any way without Landlord's written consent. Despite Landlord's efforts to provide accurate information, it is not possible to ensure it is always up to date, and Landlord assumes no responsibility for any actions taken in reliance on this information.



# KAILUA TOWN

151 Hekili St, Kailua, HI, 96734

Floor 1

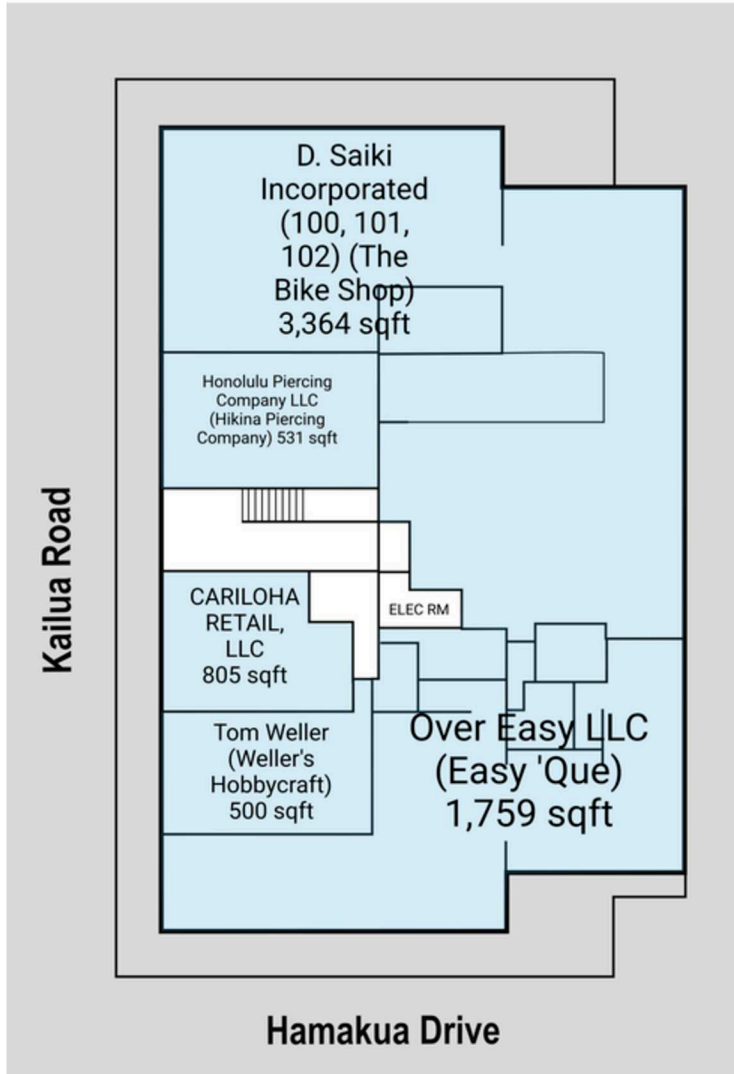

Floor 2

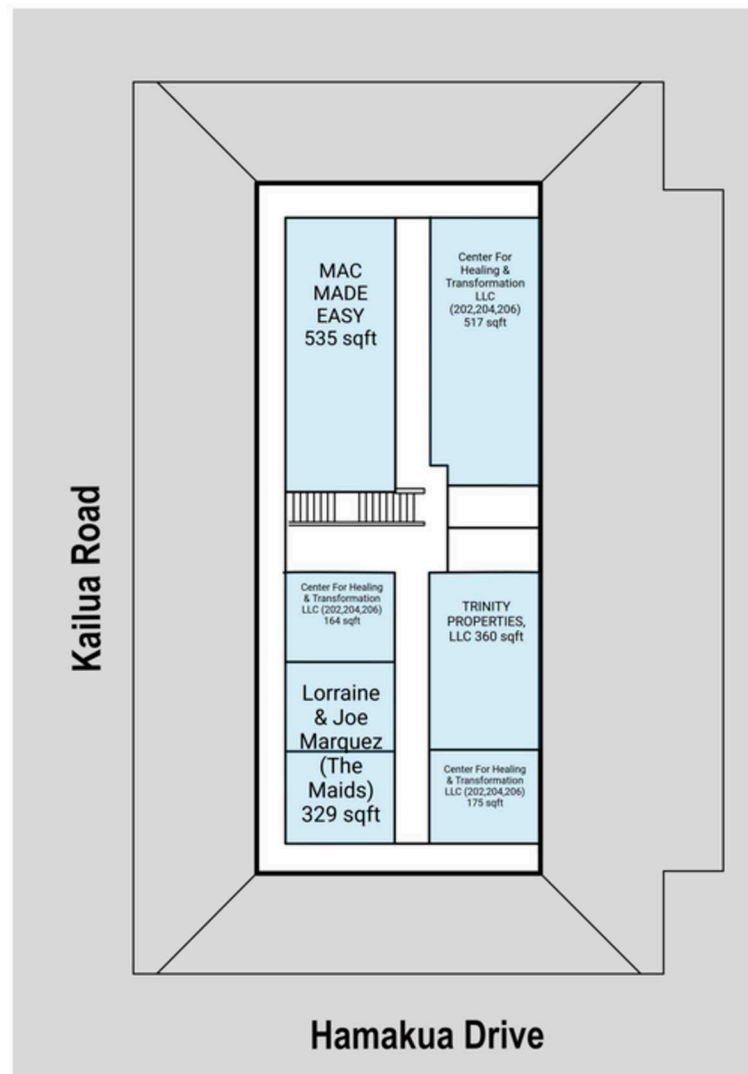

ALEXANDER & BALDWIN

822 Bishop Street, Honolulu, HI 96813 | [www.alexanderbaldwin.com](http://www.alexanderbaldwin.com)

Leasing: **Matt Schull (S)** (808) 525-6662 | [mshull@abhi.com](mailto:mshull@abhi.com)



# KAILUA TOWN

151 Hekili St, Kailua, HI, 96734

## AVAILABLE SPACES

SPACE	SF
No Availabilities	

All information is subject to change without notice. Dimensions, configurations, and frontages are approximate and any measurements are estimates. No promise is made that the spaces, common areas, amenities, landscaping, or features depicted are or will be built, or if built will be as shown. Landlord makes no representations about specific tenants or where they may operate. Unless Landlord signs a binding lease for a specific space, you do not have a right to lease any space. No content from these pages may be copied, republished, or distributed in any way without Landlord's written consent. Despite Landlord's efforts to provide accurate information, it is not possible to ensure it is always up to date, and Landlord assumes no responsibility for any actions taken in reliance on this information.



# KAILUA TOWN

151 Hekili St, Kailua, HI, 96734

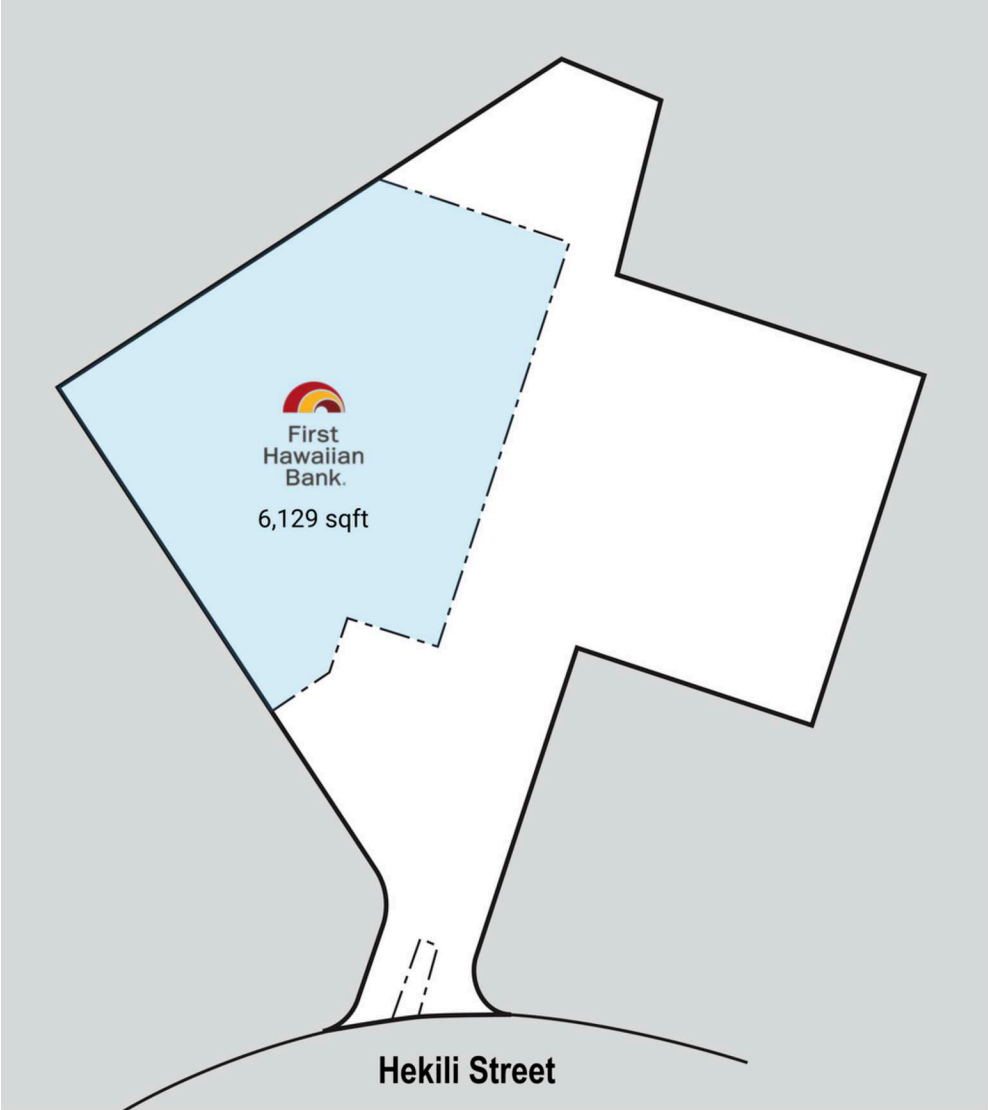



# KAILUA TOWN

151 Hekili St, Kailua, HI, 96734

## AVAILABLE SPACES

SPACE	SF
No Availabilities	

All information is subject to change without notice. Dimensions, configurations, and frontages are approximate and any measurements are estimates. No promise is made that the spaces, common areas, amenities, landscaping, or features depicted are or will be built, or if built will be as shown. Landlord makes no representations about specific tenants or where they may operate. Unless Landlord signs a binding lease for a specific space, you do not have a right to lease any space. No content from these pages may be copied, republished, or distributed in any way without Landlord's written consent. Despite Landlord's efforts to provide accurate information, it is not possible to ensure it is always up to date, and Landlord assumes no responsibility for any actions taken in reliance on this information.



# KAILUA TOWN

151 Hekili St, Kailua, HI, 96734

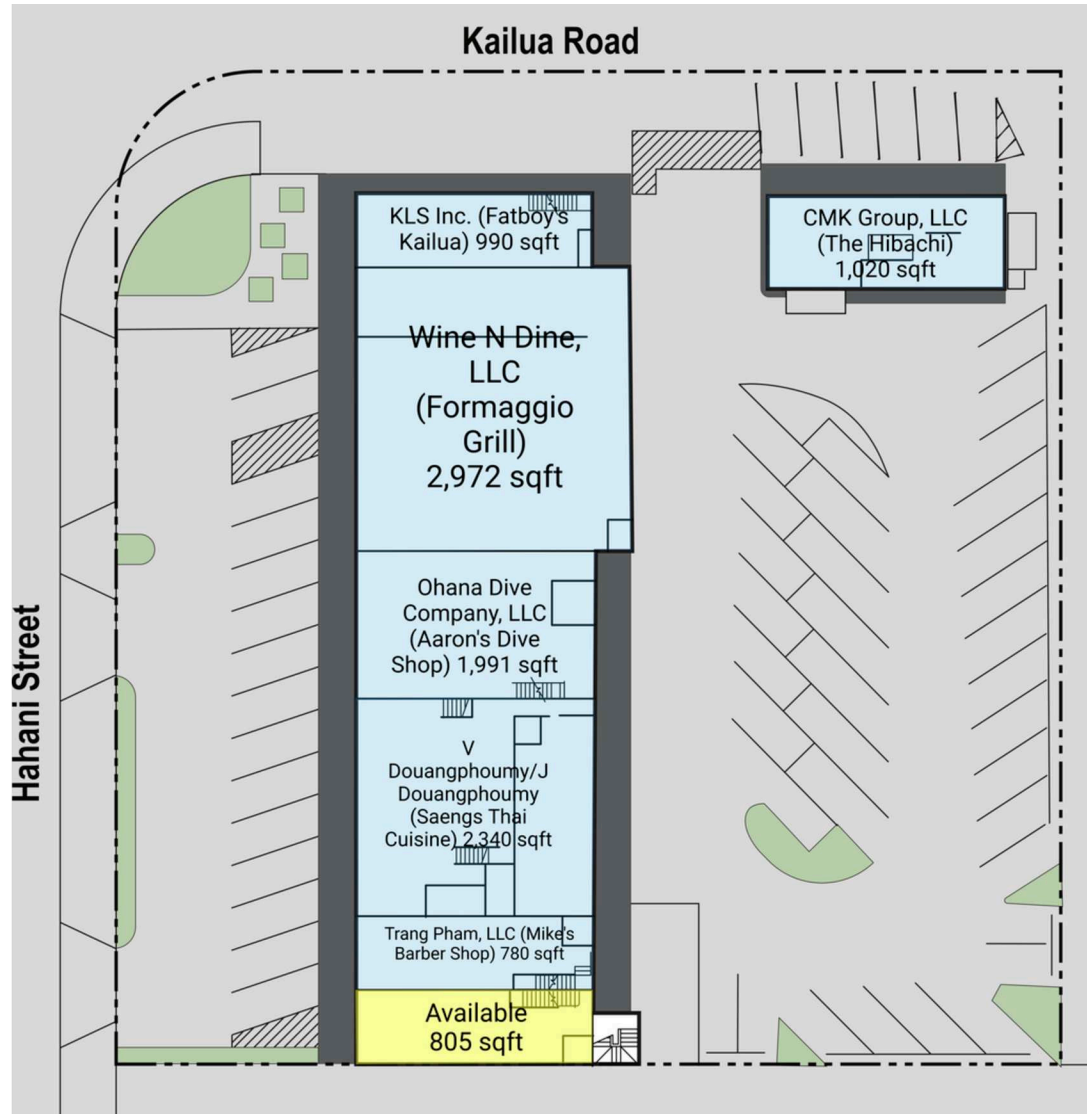

ALEXANDER & BALDWIN

822 Bishop Street, Honolulu, HI 96813 | [www.alexanderbaldwin.com](http://www.alexanderbaldwin.com)

Leasing: **Matt Schull (S)** (808) 525-6662 | [mshull@abhi.com](mailto:mshull@abhi.com)



# KAILUA TOWN

151 Hekili St, Kailua, HI, 96734

## AVAILABLE SPACES

SPACE	SF
319	805 SF

All information is subject to change without notice. Dimensions, configurations, and frontages are approximate and any measurements are estimates. No promise is made that the spaces, common areas, amenities, landscaping, or features depicted are or will be built, or if built will be as shown. Landlord makes no representations about specific tenants or where they may operate. Unless Landlord signs a binding lease for a specific space, you do not have a right to lease any space. No content from these pages may be copied, republished, or distributed in any way without Landlord's written consent. Despite Landlord's efforts to provide accurate information, it is not possible to ensure it is always up to date, and Landlord assumes no responsibility for any actions taken in reliance on this information.



ALEXANDER & BALDWIN

822 Bishop Street, Honolulu, HI 96813 | [www.alexanderbaldwin.com](http://www.alexanderbaldwin.com)

Leasing: **Matt Schull (S)** (808) 525-6662 | [mSchull@abhi.com](mailto:mSchull@abhi.com)



# KAILUA TOWN

151 Hekili St, Kailua, HI, 96734

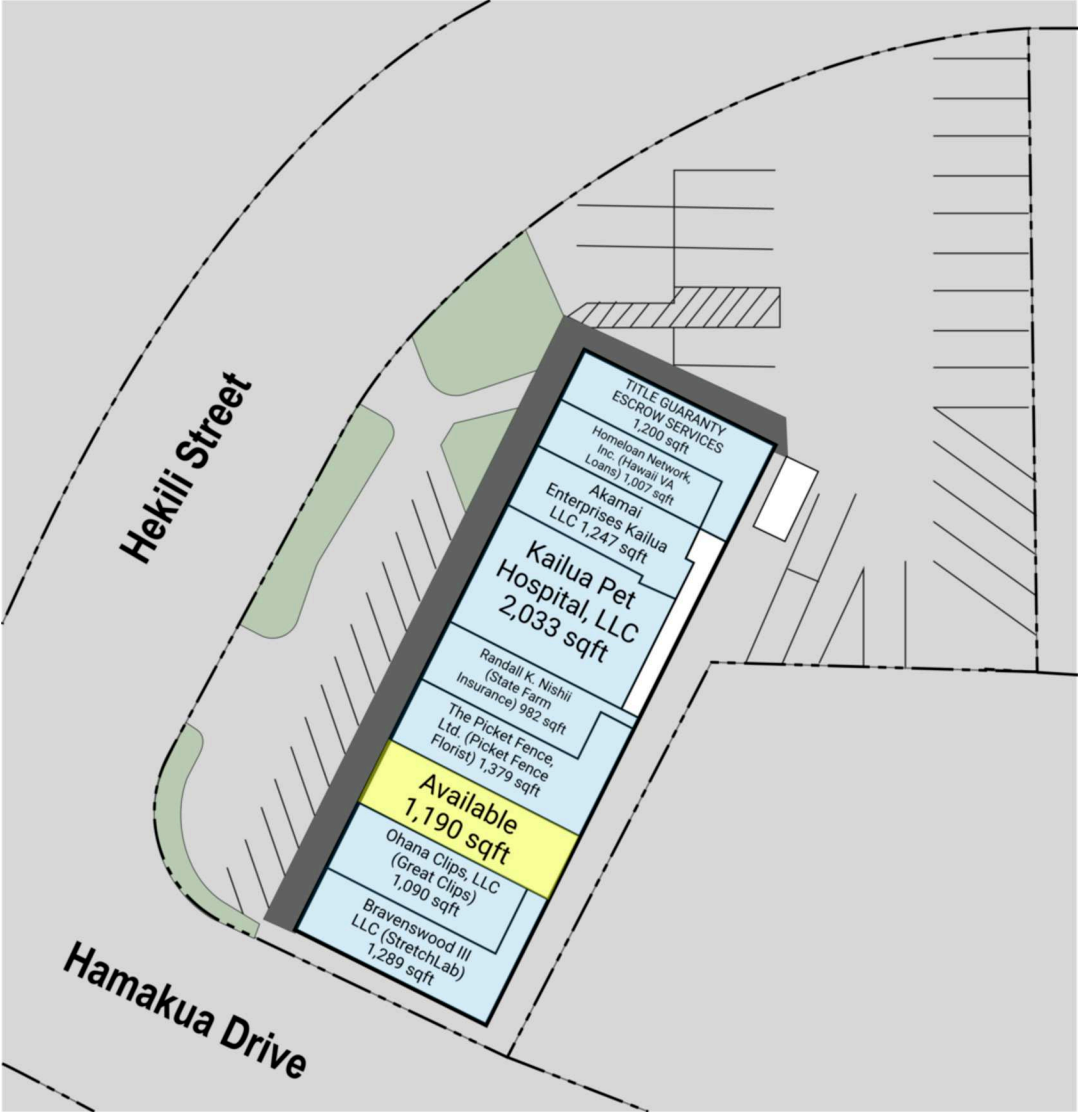

# KAILUA TOWN

151 Hekili St, Kailua, HI, 96734

## AVAILABLE SPACES

SPACE	SF
107	1,190 SF

All information is subject to change without notice. Dimensions, configurations, and frontages are approximate and any measurements are estimates. No promise is made that the spaces, common areas, amenities, landscaping, or features depicted are or will be built, or if built will be as shown. Landlord makes no representations about specific tenants or where they may operate. Unless Landlord signs a binding lease for a specific space, you do not have a right to lease any space. No content from these pages may be copied, republished, or distributed in any way without Landlord's written consent. Despite Landlord's efforts to provide accurate information, it is not possible to ensure it is always up to date, and Landlord assumes no responsibility for any actions taken in reliance on this information.



ALEXANDER & BALDWIN

822 Bishop Street, Honolulu, HI 96813 | [www.alexanderbaldwin.com](http://www.alexanderbaldwin.com)

Leasing: **Matt Schull (S)** (808) 525-6662 | [mschull@abhi.com](mailto:mschull@abhi.com)



# KAILUA TOWN

151 Hekili St, Kailua, HI, 96734

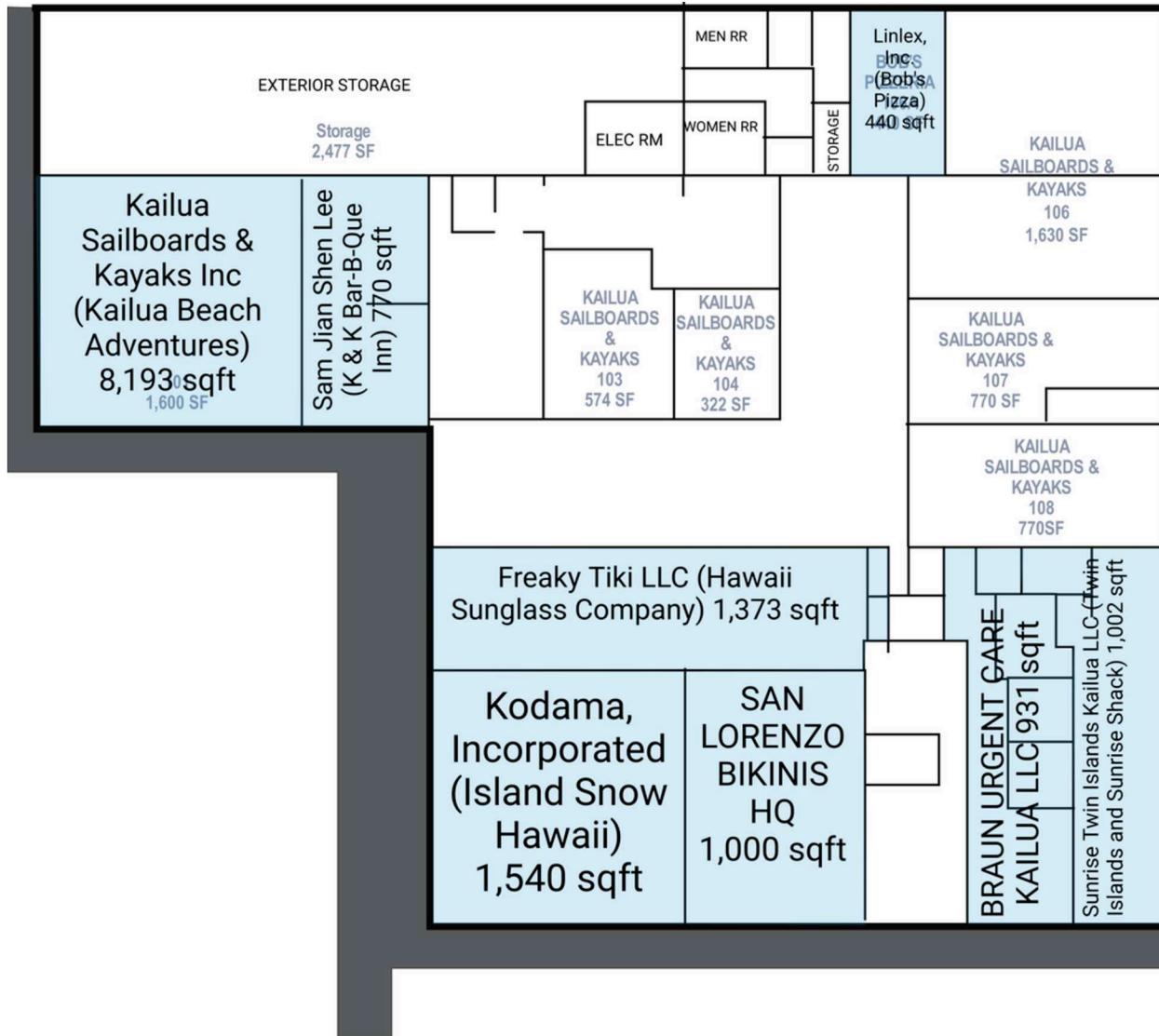

ALEXANDER & BALDWIN

822 Bishop Street, Honolulu, HI 96813 | [www.alexanderbaldwin.com](http://www.alexanderbaldwin.com)

Leasing: **Matt Schull (S)** (808) 525-6662 | [mshull@abhi.com](mailto:mshull@abhi.com)



# KAILUA TOWN

151 Hekili St, Kailua, HI, 96734

## AVAILABLE SPACES

SPACE	SF
No Availabilities	

All information is subject to change without notice. Dimensions, configurations, and frontages are approximate and any measurements are estimates. No promise is made that the spaces, common areas, amenities, landscaping, or features depicted are or will be built, or if built will be as shown. Landlord makes no representations about specific tenants or where they may operate. Unless Landlord signs a binding lease for a specific space, you do not have a right to lease any space. No content from these pages may be copied, republished, or distributed in any way without Landlord's written consent. Despite Landlord's efforts to provide accurate information, it is not possible to ensure it is always up to date, and Landlord assumes no responsibility for any actions taken in reliance on this information.



ALEXANDER & BALDWIN

822 Bishop Street, Honolulu, HI 96813 | [www.alexanderbaldwin.com](http://www.alexanderbaldwin.com)

Leasing: **Matt Schull (S)** (808) 525-6662 | [mschull@abhi.com](mailto:mschull@abhi.com)



# KAILUA TOWN

151 Hekili St, Kailua, HI, 96734





# KAILUA TOWN

151 Hekili St, Kailua, HI, 96734

## AVAILABLE SPACES

SPACE	SF
102	860 SF

All information is subject to change without notice. Dimensions, configurations, and frontages are approximate and any measurements are estimates. No promise is made that the spaces, common areas, amenities, landscaping, or features depicted are or will be built, or if built will be as shown. Landlord makes no representations about specific tenants or where they may operate. Unless Landlord signs a binding lease for a specific space, you do not have a right to lease any space. No content from these pages may be copied, republished, or distributed in any way without Landlord's written consent. Despite Landlord's efforts to provide accurate information, it is not possible to ensure it is always up to date, and Landlord assumes no responsibility for any actions taken in reliance on this information.



ALEXANDER & BALDWIN

822 Bishop Street, Honolulu, HI 96813 | [www.alexanderbaldwin.com](http://www.alexanderbaldwin.com)

Leasing: **Matt Schull (S)** (808) 525-6662 | [mschull@abhi.com](mailto:mschull@abhi.com)



# KAILUA TOWN

151 Hekili St, Kailua, HI, 96734

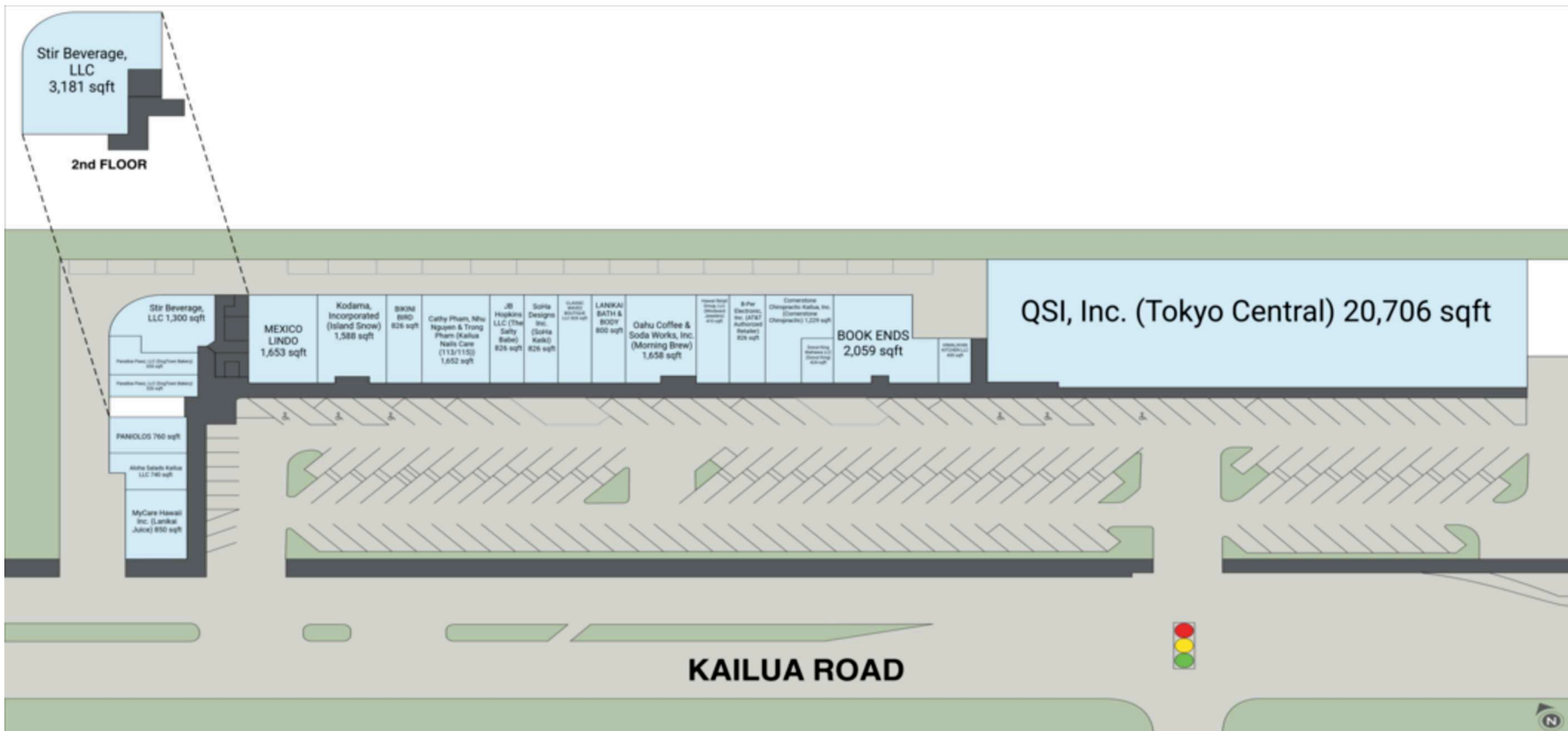

ALEXANDER & BALDWIN

822 Bishop Street, Honolulu, HI 96813 | [www.alexanderbaldwin.com](http://www.alexanderbaldwin.com)

Leasing: **Matt Schull (S)** (808) 525-6662 | [mshull@abhi.com](mailto:mshull@abhi.com)



# KAILUA TOWN

151 Hekili St, Kailua, HI, 96734

## AVAILABLE SPACES

SPACE	SF
107B	130 SF

All information is subject to change without notice. Dimensions, configurations, and frontages are approximate and any measurements are estimates. No promise is made that the spaces, common areas, amenities, landscaping, or features depicted are or will be built, or if built will be as shown. Landlord makes no representations about specific tenants or where they may operate. Unless Landlord signs a binding lease for a specific space, you do not have a right to lease any space. No content from these pages may be copied, republished, or distributed in any way without Landlord's written consent. Despite Landlord's efforts to provide accurate information, it is not possible to ensure it is always up to date, and Landlord assumes no responsibility for any actions taken in reliance on this information.



ALEXANDER & BALDWIN

822 Bishop Street, Honolulu, HI 96813 | [www.alexanderbaldwin.com](http://www.alexanderbaldwin.com)

Leasing: **Matt Schull (S)** (808) 525-6662 | [mschull@abhi.com](mailto:mschull@abhi.com)



# KAILUA TOWN

151 Hekili St, Kailua, HI, 96734

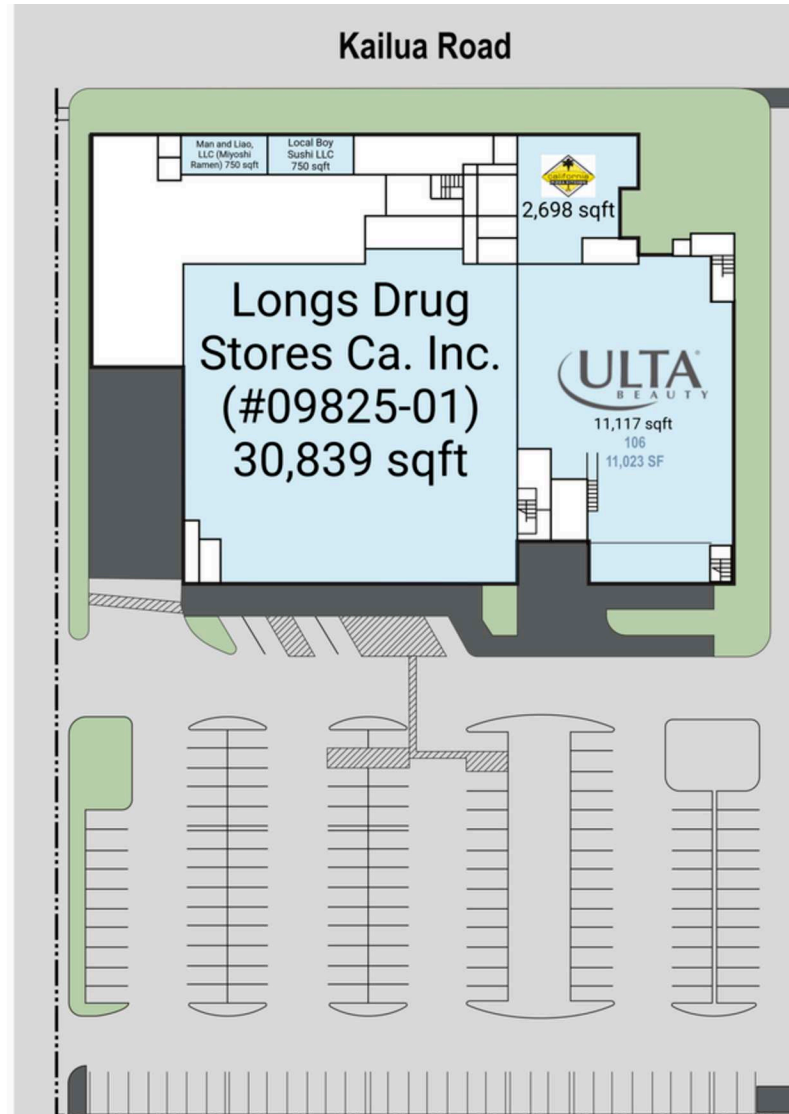
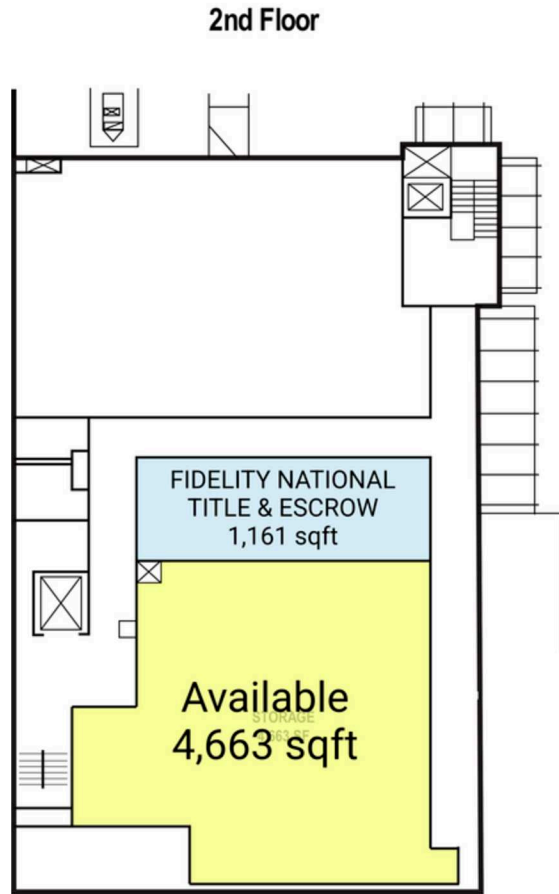

ALEXANDER & BALDWIN

822 Bishop Street, Honolulu, HI 96813 | [www.alexanderbaldwin.com](http://www.alexanderbaldwin.com)

Leasing: **Matt Schull (S)** (808) 525-6662 | [mschull@abhi.com](mailto:mschull@abhi.com)



# KAILUA TOWN

151 Hekili St, Kailua, HI, 96734

## AVAILABLE SPACES

SPACE	SF	SPACE	SF
200A	1,388 SF	206	4,663 SF

All information is subject to change without notice. Dimensions, configurations, and frontages are approximate and any measurements are estimates. No promise is made that the spaces, common areas, amenities, landscaping, or features depicted are or will be built, or if built will be as shown. Landlord makes no representations about specific tenants or where they may operate. Unless Landlord signs a binding lease for a specific space, you do not have a right to lease any space. No content from these pages may be copied, republished, or distributed in any way without Landlord's written consent. Despite Landlord's efforts to provide accurate information, it is not possible to ensure it is always up to date, and Landlord assumes no responsibility for any actions taken in reliance on this information.



822 Bishop Street, Honolulu, HI 96813 | [www.alexanderbaldwin.com](http://www.alexanderbaldwin.com)

Leasing: **Matt Schull (S)** (808) 525-6662 | [mSchull@abhi.com](mailto:mSchull@abhi.com)



# KAILUA TOWN

151 Hekili St, Kailua, HI, 96734



ALEXANDER & BALDWIN

822 Bishop Street, Honolulu, HI 96813 | [www.alexanderbaldwin.com](http://www.alexanderbaldwin.com)

Leasing: **Matt Schull (S)** (808) 525-6662 | [mshull@abhi.com](mailto:mshull@abhi.com)



# KAILUA TOWN

151 Hekili St, Kailua, HI, 96734

## AVAILABLE SPACES

SPACE	SF
No Availabilities	

All information is subject to change without notice. Dimensions, configurations, and frontages are approximate and any measurements are estimates. No promise is made that the spaces, common areas, amenities, landscaping, or features depicted are or will be built, or if built will be as shown. Landlord makes no representations about specific tenants or where they may operate. Unless Landlord signs a binding lease for a specific space, you do not have a right to lease any space. No content from these pages may be copied, republished, or distributed in any way without Landlord's written consent. Despite Landlord's efforts to provide accurate information, it is not possible to ensure it is always up to date, and Landlord assumes no responsibility for any actions taken in reliance on this information.



# KAILUA TOWN

151 Hekili St, Kailua, HI, 96734

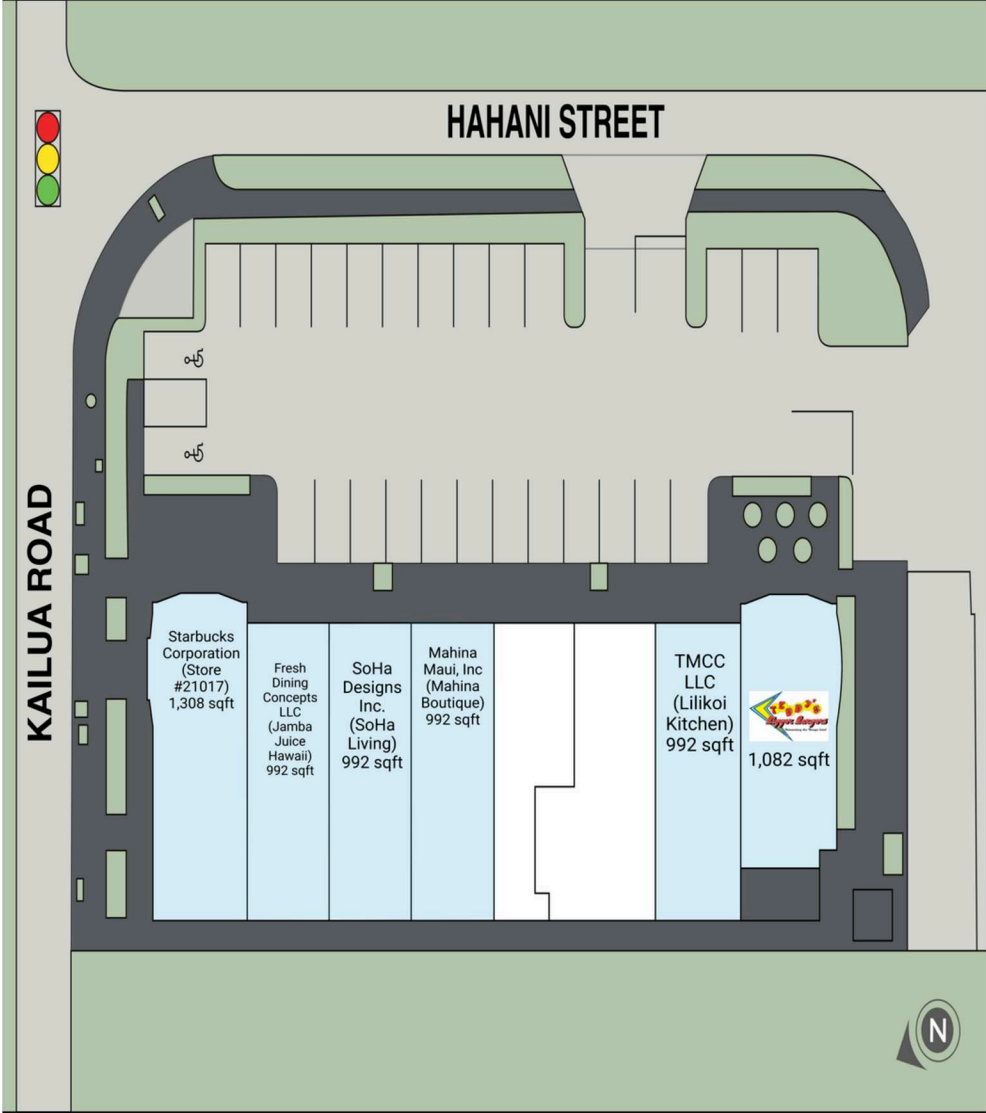



# KAILUA TOWN

151 Hekili St, Kailua, HI, 96734

## AVAILABLE SPACES

SPACE	SF
No Availabilities	

All information is subject to change without notice. Dimensions, configurations, and frontages are approximate and any measurements are estimates. No promise is made that the spaces, common areas, amenities, landscaping, or features depicted are or will be built, or if built will be as shown. Landlord makes no representations about specific tenants or where they may operate. Unless Landlord signs a binding lease for a specific space, you do not have a right to lease any space. No content from these pages may be copied, republished, or distributed in any way without Landlord's written consent. Despite Landlord's efforts to provide accurate information, it is not possible to ensure it is always up to date, and Landlord assumes no responsibility for any actions taken in reliance on this information.



ALEXANDER & BALDWIN

822 Bishop Street, Honolulu, HI 96813 | [www.alexanderbaldwin.com](http://www.alexanderbaldwin.com)

Leasing: **Matt Schull (S)** (808) 525-6662 | [mschull@abhi.com](mailto:mschull@abhi.com)



# KAILUA TOWN

151 Hekili St, Kailua, HI, 96734

## Hekili Street

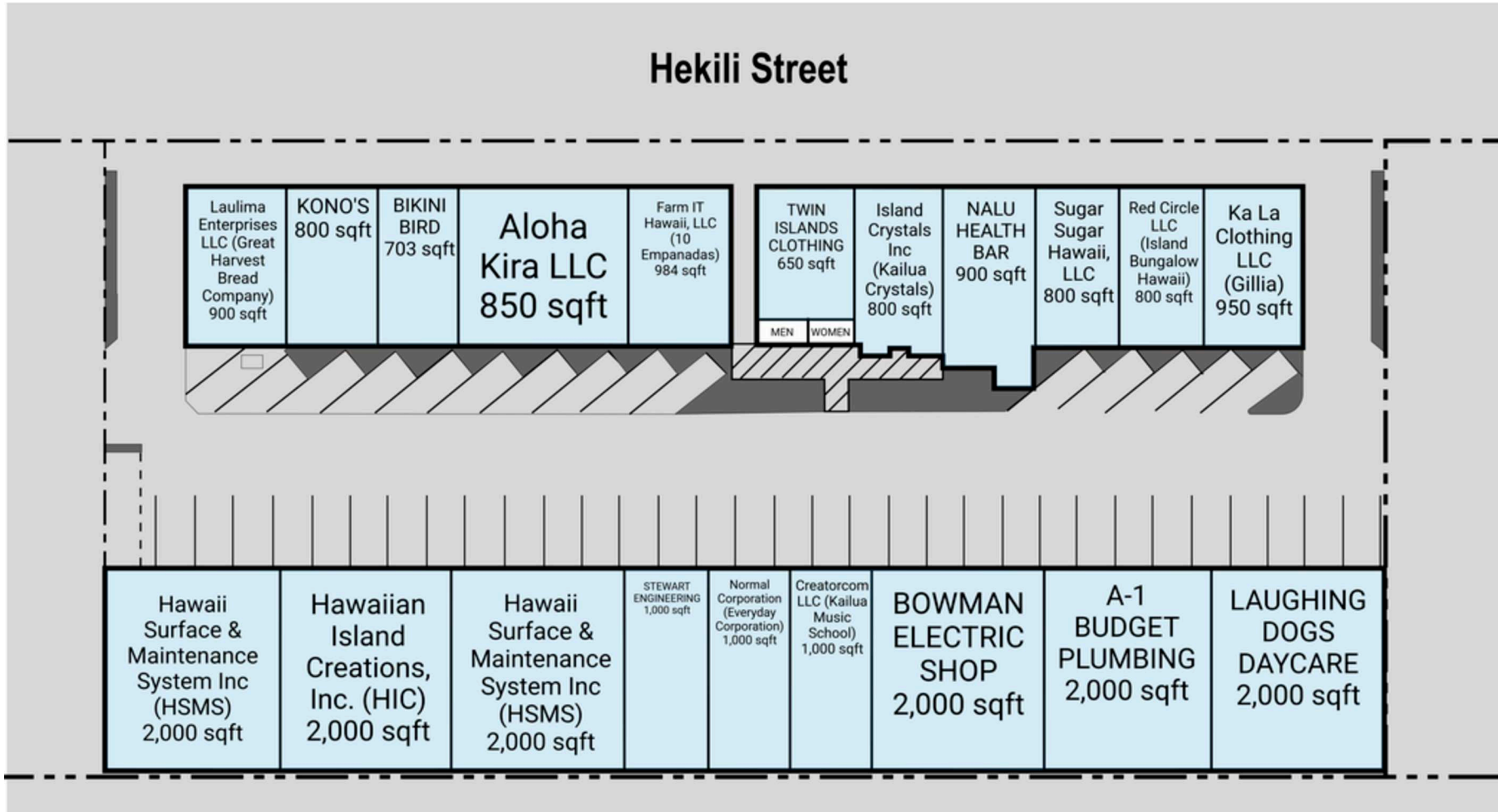

ALEXANDER & BALDWIN

822 Bishop Street, Honolulu, HI 96813 | [www.alexanderbaldwin.com](http://www.alexanderbaldwin.com)

Leasing: **Matt Schull (S)** (808) 525-6662 | [mshull@abhi.com](mailto:mshull@abhi.com)



# KAILUA TOWN

151 Hekili St, Kailua, HI, 96734

## AVAILABLE SPACES

SPACE	SF
No Availabilities	

All information is subject to change without notice. Dimensions, configurations, and frontages are approximate and any measurements are estimates. No promise is made that the spaces, common areas, amenities, landscaping, or features depicted are or will be built, or if built will be as shown. Landlord makes no representations about specific tenants or where they may operate. Unless Landlord signs a binding lease for a specific space, you do not have a right to lease any space. No content from these pages may be copied, republished, or distributed in any way without Landlord's written consent. Despite Landlord's efforts to provide accurate information, it is not possible to ensure it is always up to date, and Landlord assumes no responsibility for any actions taken in reliance on this information.



ALEXANDER & BALDWIN

822 Bishop Street, Honolulu, HI 96813 | [www.alexanderbaldwin.com](http://www.alexanderbaldwin.com)

Leasing: **Matt Schull (S)** (808) 525-6662 | [mschull@abhi.com](mailto:mschull@abhi.com)



# KAILUA TOWN

151 Hekili St, Kailua, HI, 96734

Floor 1

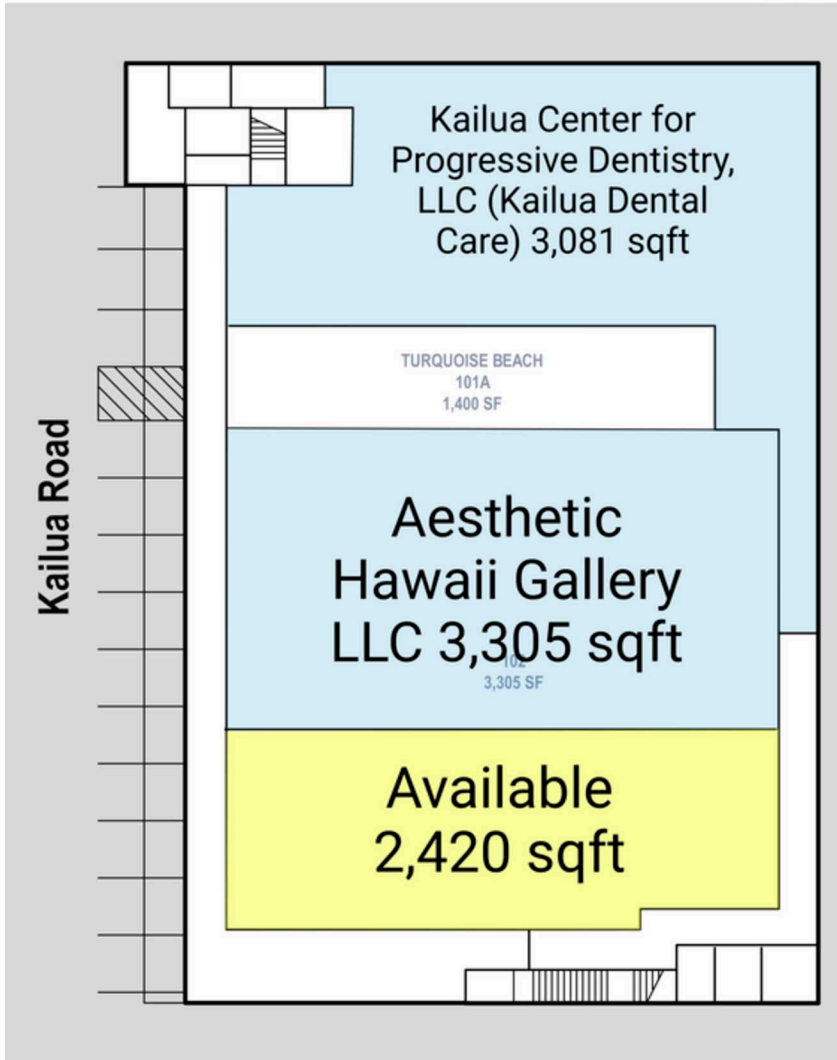

Floor 2

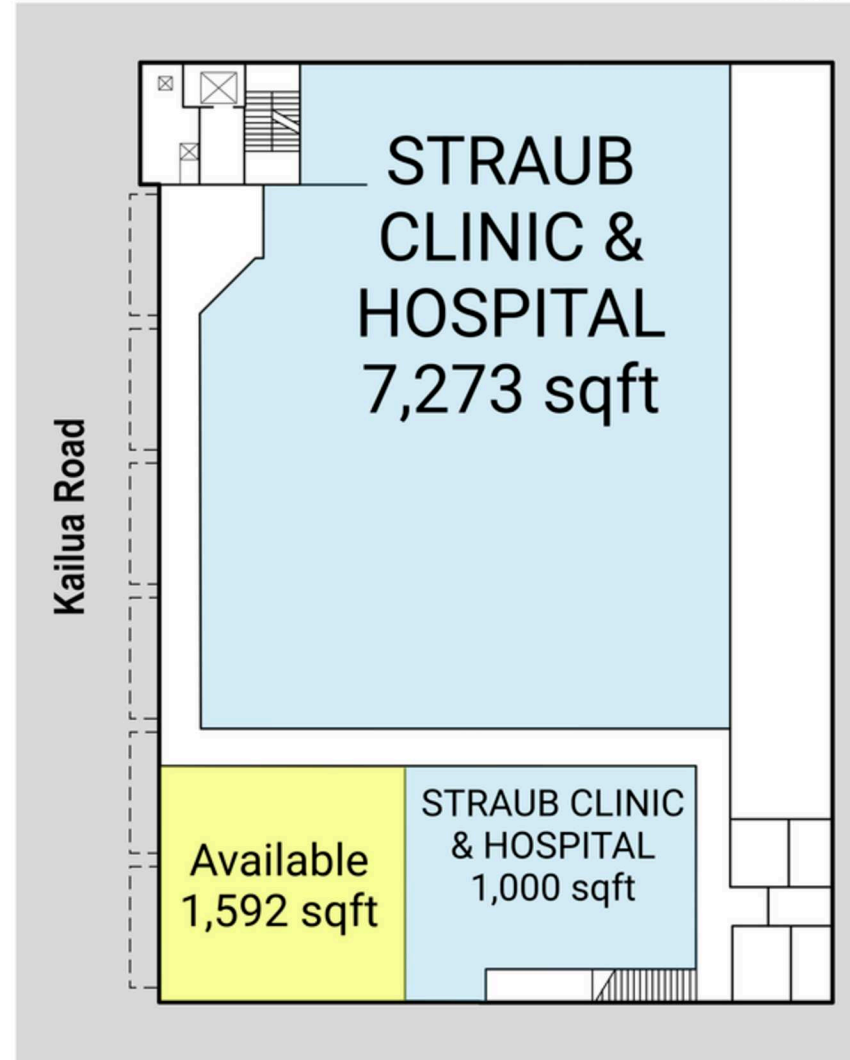

ALEXANDER & BALDWIN

822 Bishop Street, Honolulu, HI 96813 | [www.alexanderbaldwin.com](http://www.alexanderbaldwin.com)

Leasing: **Matt Schull (S)** (808) 525-6662 | [mshull@abhi.com](mailto:mshull@abhi.com)



# KAILUA TOWN

151 Hekili St, Kailua, HI, 96734

## AVAILABLE SPACES

SPACE	SF	SPACE	SF
103_S	2,420 SF	201_S	1,592 SF

All information is subject to change without notice. Dimensions, configurations, and frontages are approximate and any measurements are estimates. No promise is made that the spaces, common areas, amenities, landscaping, or features depicted are or will be built, or if built will be as shown. Landlord makes no representations about specific tenants or where they may operate. Unless Landlord signs a binding lease for a specific space, you do not have a right to lease any space. No content from these pages may be copied, republished, or distributed in any way without Landlord's written consent. Despite Landlord's efforts to provide accurate information, it is not possible to ensure it is always up to date, and Landlord assumes no responsibility for any actions taken in reliance on this information.



ALEXANDER & BALDWIN

822 Bishop Street, Honolulu, HI 96813 | [www.alexanderbaldwin.com](http://www.alexanderbaldwin.com)

Leasing: **Matt Schull (S)** (808) 525-6662 | [mschull@abhi.com](mailto:mschull@abhi.com)



# KAILUA TOWN

151 Hekili St, Kailua, HI, 96734

## Floor 1

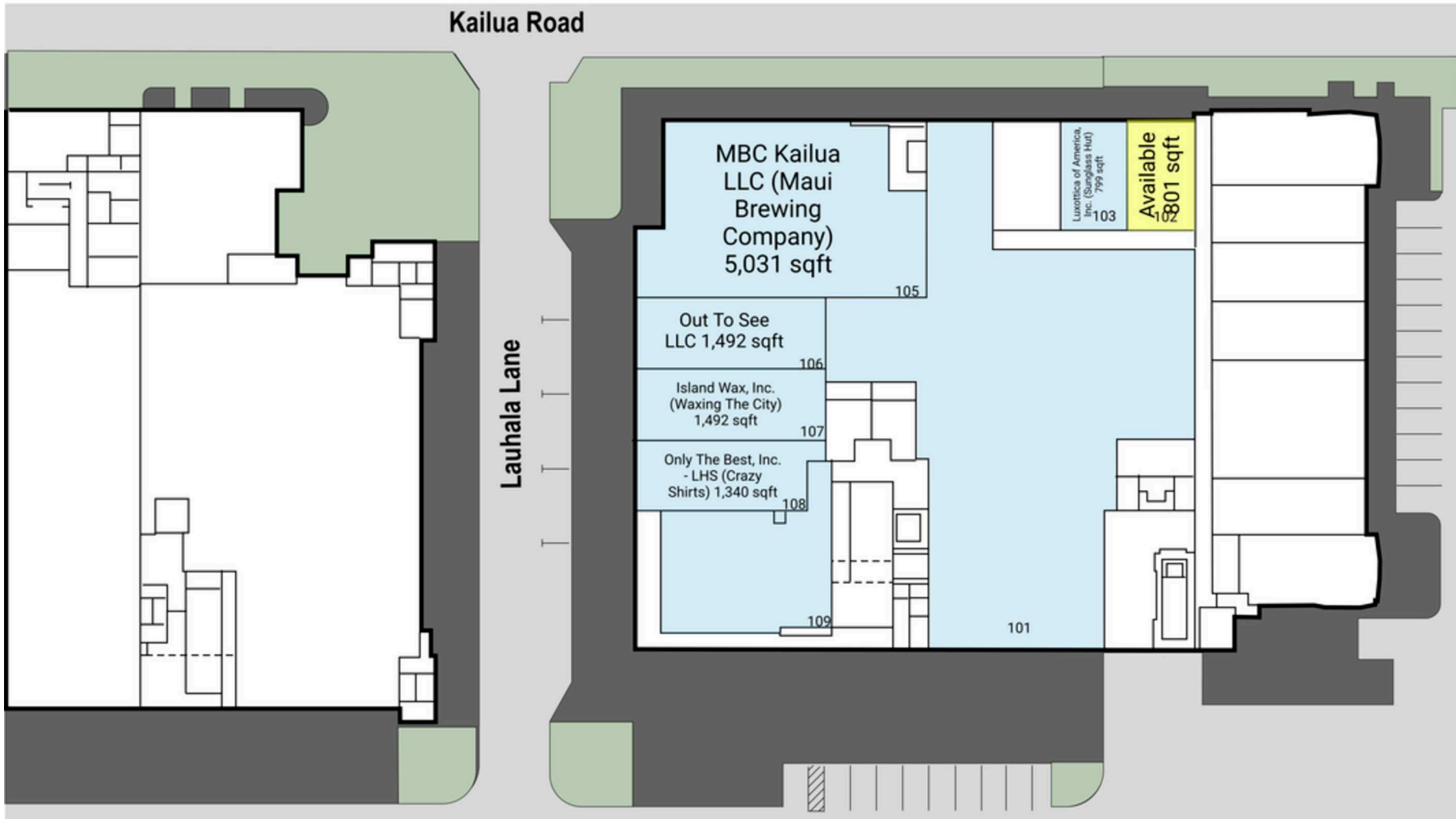

ALEXANDER & BALDWIN

822 Bishop Street, Honolulu, HI 96813 | [www.alexanderbaldwin.com](http://www.alexanderbaldwin.com)

Leasing: **Matt Schull (S)** (808) 525-6662 | [mshull@abhi.com](mailto:mshull@abhi.com)



# KAILUA TOWN

151 Hekili St, Kailua, HI, 96734

## AVAILABLE SPACES

SPACE	SF
102	801 SF

All information is subject to change without notice. Dimensions, configurations, and frontages are approximate and any measurements are estimates. No promise is made that the spaces, common areas, amenities, landscaping, or features depicted are or will be built, or if built will be as shown. Landlord makes no representations about specific tenants or where they may operate. Unless Landlord signs a binding lease for a specific space, you do not have a right to lease any space. No content from these pages may be copied, republished, or distributed in any way without Landlord's written consent. Despite Landlord's efforts to provide accurate information, it is not possible to ensure it is always up to date, and Landlord assumes no responsibility for any actions taken in reliance on this information.



ALEXANDER & BALDWIN

822 Bishop Street, Honolulu, HI 96813 | [www.alexanderbaldwin.com](http://www.alexanderbaldwin.com)

Leasing: **Matt Schull (S)** (808) 525-6662 | [mschull@abhi.com](mailto:mschull@abhi.com)



# KAILUA TOWN

151 Hekili St, Kailua, HI, 96734

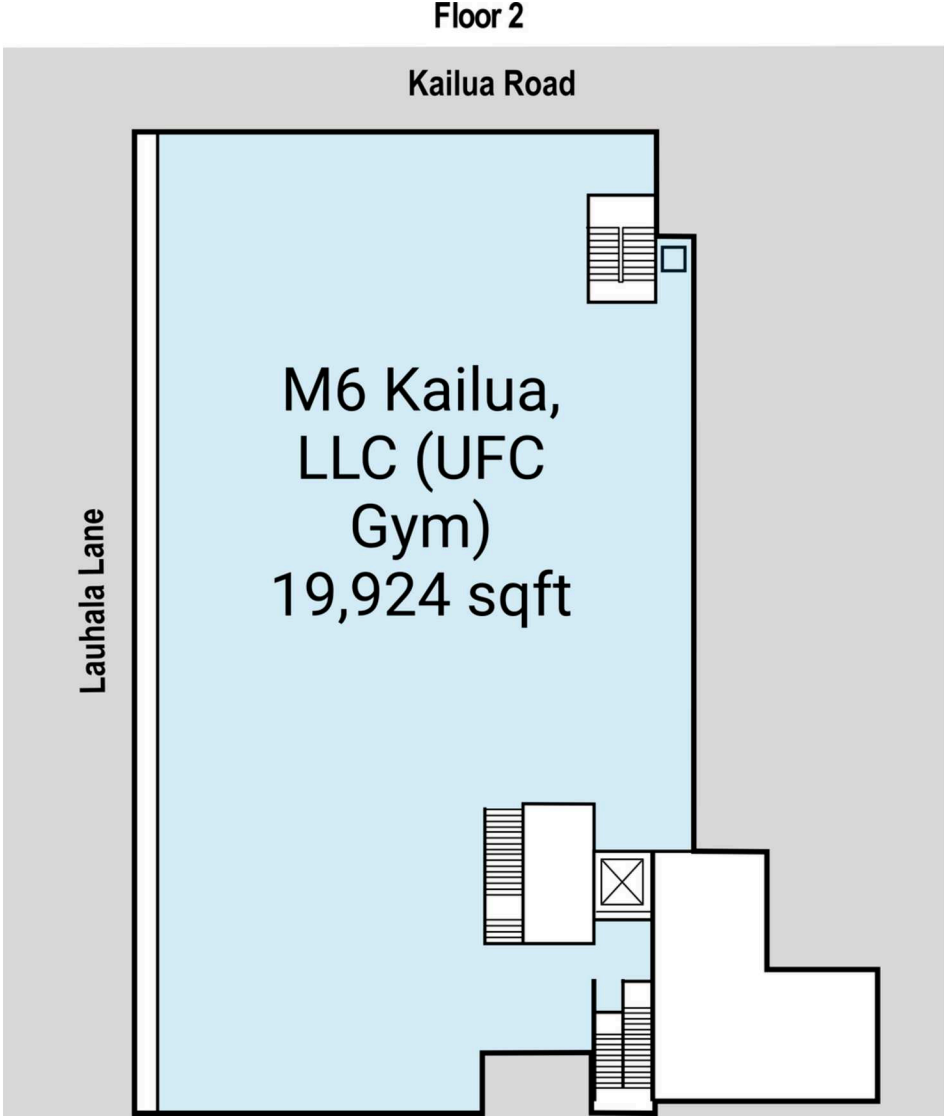



# KAILUA TOWN

151 Hekili St, Kailua, HI, 96734

## AVAILABLE SPACES

SPACE	SF
No Availabilities	

All information is subject to change without notice. Dimensions, configurations, and frontages are approximate and any measurements are estimates. No promise is made that the spaces, common areas, amenities, landscaping, or features depicted are or will be built, or if built will be as shown. Landlord makes no representations about specific tenants or where they may operate. Unless Landlord signs a binding lease for a specific space, you do not have a right to lease any space. No content from these pages may be copied, republished, or distributed in any way without Landlord's written consent. Despite Landlord's efforts to provide accurate information, it is not possible to ensure it is always up to date, and Landlord assumes no responsibility for any actions taken in reliance on this information.



# KAILUA TOWN

151 Hekili St, Kailua, HI, 96734



ALEXANDER & BALDWIN

822 Bishop Street, Honolulu, HI 96813 | [www.alexanderbaldwin.com](http://www.alexanderbaldwin.com)

Leasing: **Matt Schull (S)** (808) 525-6662 | [mSchull@abhi.com](mailto:mSchull@abhi.com)



# KAILUA TOWN

151 Hekili St, Kailua, HI, 96734

## AVAILABLE SPACES

SPACE	SF
No Availabilities	

All information is subject to change without notice. Dimensions, configurations, and frontages are approximate and any measurements are estimates. No promise is made that the spaces, common areas, amenities, landscaping, or features depicted are or will be built, or if built will be as shown. Landlord makes no representations about specific tenants or where they may operate. Unless Landlord signs a binding lease for a specific space, you do not have a right to lease any space. No content from these pages may be copied, republished, or distributed in any way without Landlord's written consent. Despite Landlord's efforts to provide accurate information, it is not possible to ensure it is always up to date, and Landlord assumes no responsibility for any actions taken in reliance on this information.



# KAILUA TOWN

151 Hekili St, Kailua, HI, 96734



ALEXANDER & BALDWIN

822 Bishop Street, Honolulu, HI 96813 | [www.alexanderbaldwin.com](http://www.alexanderbaldwin.com)

Leasing: **Matt Schull (S)** (808) 525-6662 | [mSchull@abhi.com](mailto:mSchull@abhi.com)



# KAILUA TOWN

151 Hekili St, Kailua, HI, 96734

## AVAILABLE SPACES

SPACE	SF
203A	164 SF

All information is subject to change without notice. Dimensions, configurations, and frontages are approximate and any measurements are estimates. No promise is made that the spaces, common areas, amenities, landscaping, or features depicted are or will be built, or if built will be as shown. Landlord makes no representations about specific tenants or where they may operate. Unless Landlord signs a binding lease for a specific space, you do not have a right to lease any space. No content from these pages may be copied, republished, or distributed in any way without Landlord's written consent. Despite Landlord's efforts to provide accurate information, it is not possible to ensure it is always up to date, and Landlord assumes no responsibility for any actions taken in reliance on this information.



ALEXANDER & BALDWIN

822 Bishop Street, Honolulu, HI 96813 | [www.alexanderbaldwin.com](http://www.alexanderbaldwin.com)

Leasing: **Matt Schull (S)** (808) 525-6662 | [mschull@abhi.com](mailto:mschull@abhi.com)

