

MANOA MARKETPLACE

2851 East Manoa Road, Honolulu, HI, 96822



PROPERTY

Manoa Marketplace is the only grocery-anchored center located in the vibrant and storied community of beautiful Manoa Valley. The neighborhood shopping center attracts residential neighbors boasting above-average household and discretionary income, students from the nearby UH Manoa campus and a number of prestigious private and public schools. Situated along the main arterial E. Manoa Road, the center also benefits from the tourism traffic from the popular Manoa Falls hiking trail.

CENTER SIZE

141,400 SF



2021 DEMOGRAPHICS	1-Mile	3-Mile	5-Mile
Estimated Population	17,307	204,780	314,970
2021 Projected Population	17,307	204,780	314,970
Total Households	4,994	87,801	122,099
Average Household Income	\$163,472	\$100,532	\$104,426
Daytime Population	17,738	241,453	381,146
Median Age	38	45	45
Bachelor Degree or Higher	61%	45%	41%
TRAFFIC COUNTS			
1 Woodlawn Drive @ Lowrey Ave	46,595 ADT		
2 Woodlawn Drive @ Lowry Ave	32,828 ADT		



MANOA MARKETPLACE

2851 East Manoa Road, Honolulu, HI, 96822

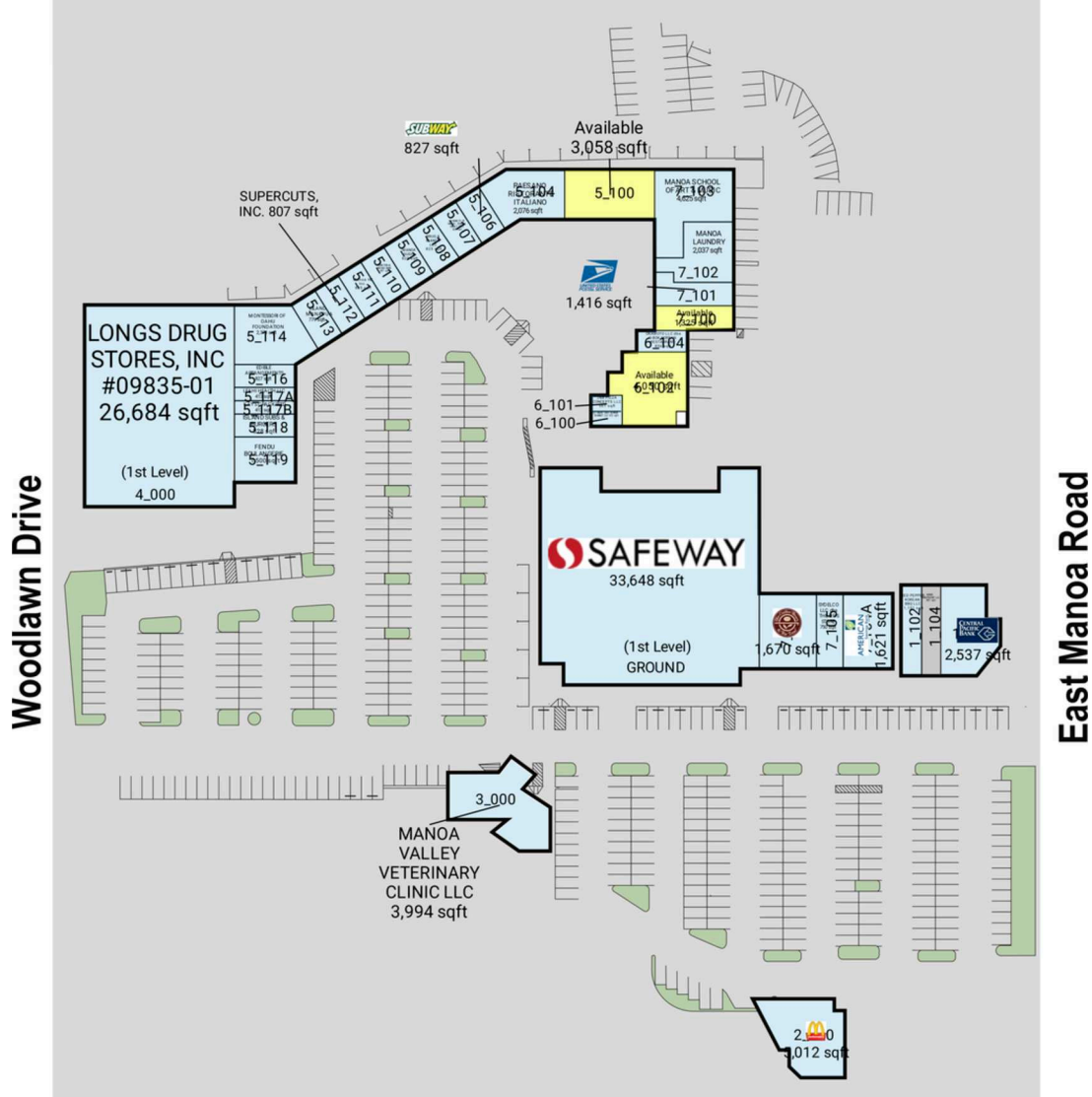

ALEXANDER & BALDWIN

822 Bishop Street, Honolulu, HI 96813 | www.alexanderbaldwin.com

Leasing: **Aja M. S. Shimamura (S)** (808) 525-6662 | ashimamura@abhi.com



MANOA MARKETPLACE

2851 East Manoa Road, Honolulu, HI, 96822

AVAILABLE SPACES

SPACE	SF
1_204	1,181 SF
3_100	1,005 SF
5_100	3,058 SF
5_204B	710 SF
5_213	767 SF

SPACE	SF
5_215	366 SF
5_217	1,002 SF
6_102	4,050 SF
7_100	1,325 SF

All information is subject to change without notice. Dimensions, configurations, and frontages are approximate and any measurements are estimates. No promise is made that the spaces, common areas, amenities, landscaping, or features depicted are or will be built, or if built will be as shown. Landlord makes no representations about specific tenants or where they may operate. Unless Landlord signs a binding lease for a specific space, you do not have a right to lease any space. No content from these pages may be copied, republished, or distributed in any way without Landlord's written consent. Despite Landlord's efforts to provide accurate information, it is not possible to ensure it is always up to date, and Landlord assumes no responsibility for any actions taken in reliance on this information.



ALEXANDER & BALDWIN

822 Bishop Street, Honolulu, HI 96813 | www.alexanderbaldwin.com

Leasing: **Aja M. S. Shimamura (S)** (808) 525-6662 | ashimamura@abhi.com



MANOA MARKETPLACE

2851 East Manoa Road, Honolulu, HI, 96822

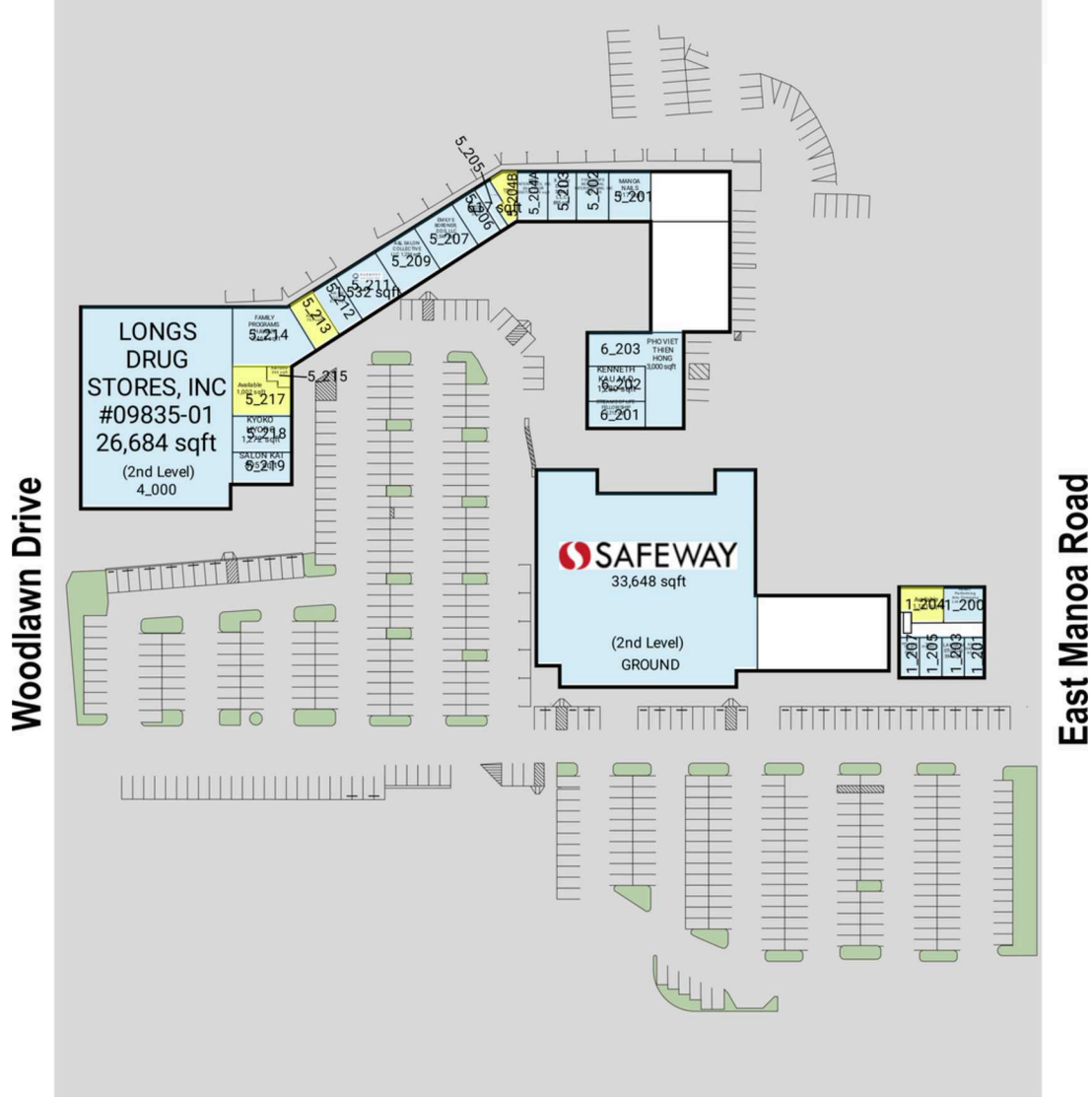

ALEXANDER & BALDWIN

822 Bishop Street, Honolulu, HI 96813 | www.alexanderbaldwin.com

Leasing: **Aja M. S. Shimamura (S)** (808) 525-6662 | ashimamura@abhi.com



MANOA MARKETPLACE

2851 East Manoa Road, Honolulu, HI, 96822

AVAILABLE SPACES

SPACE	SF
1_204	1,181 SF
3_100	1,005 SF
5_100	3,058 SF
5_204B	710 SF
5_213	767 SF

SPACE	SF
5_215	366 SF
5_217	1,002 SF
6_102	4,050 SF
7_100	1,325 SF

All information is subject to change without notice. Dimensions, configurations, and frontages are approximate and any measurements are estimates. No promise is made that the spaces, common areas, amenities, landscaping, or features depicted are or will be built, or if built will be as shown. Landlord makes no representations about specific tenants or where they may operate. Unless Landlord signs a binding lease for a specific space, you do not have a right to lease any space. No content from these pages may be copied, republished, or distributed in any way without Landlord's written consent. Despite Landlord's efforts to provide accurate information, it is not possible to ensure it is always up to date, and Landlord assumes no responsibility for any actions taken in reliance on this information.



ALEXANDER & BALDWIN

822 Bishop Street, Honolulu, HI 96813 | www.alexanderbaldwin.com

Leasing: **Aja M. S. Shimamura (S)** (808) 525-6662 | ashimamura@abhi.com

