

WAIPIO SHOPPING CENTER

94-1040 Waipio Uka Street, Waipahu, HI, 96797



PROPERTY

Neighborhood center anchored by Foodland Supermarket is located in the master-planned community of Waipio in Central Oahu. It is the sole grocery-anchored center in Waipio, and neighboring Waikele, Crestview and Mililani communities. The center is ideally situated across from the 270-acre Central Oahu Regional Park and is located less than two miles from Oahu's primary freeway arterials.

CENTER SIZE

113,800 SF

2021 DEMOGRAPHICS

	1-Mile	3-Mile	5-Mile
Estimated Population	17,633	122,127	206,856
2021 Projected Population	17,633	122,127	206,856
Total Households	5,911	33,433	61,047
Average Household Income	\$109,646	\$113,083	\$116,491
Daytime Population	15,975	101,433	172,710
Median Age	40	39	39
Bachelor Degree or Higher	34%	28%	32%



ALEXANDER & BALDWIN

822 Bishop Street, Honolulu, HI 96813 | www.alexanderbaldwin.com

Leasing: **Aja M. S. Shimamura (S)** (808) 525-6662 | ashimamura@abhi.com



WAIPIO SHOPPING CENTER

94-1040 Waipio Uka Street, Waipahu, HI, 96797

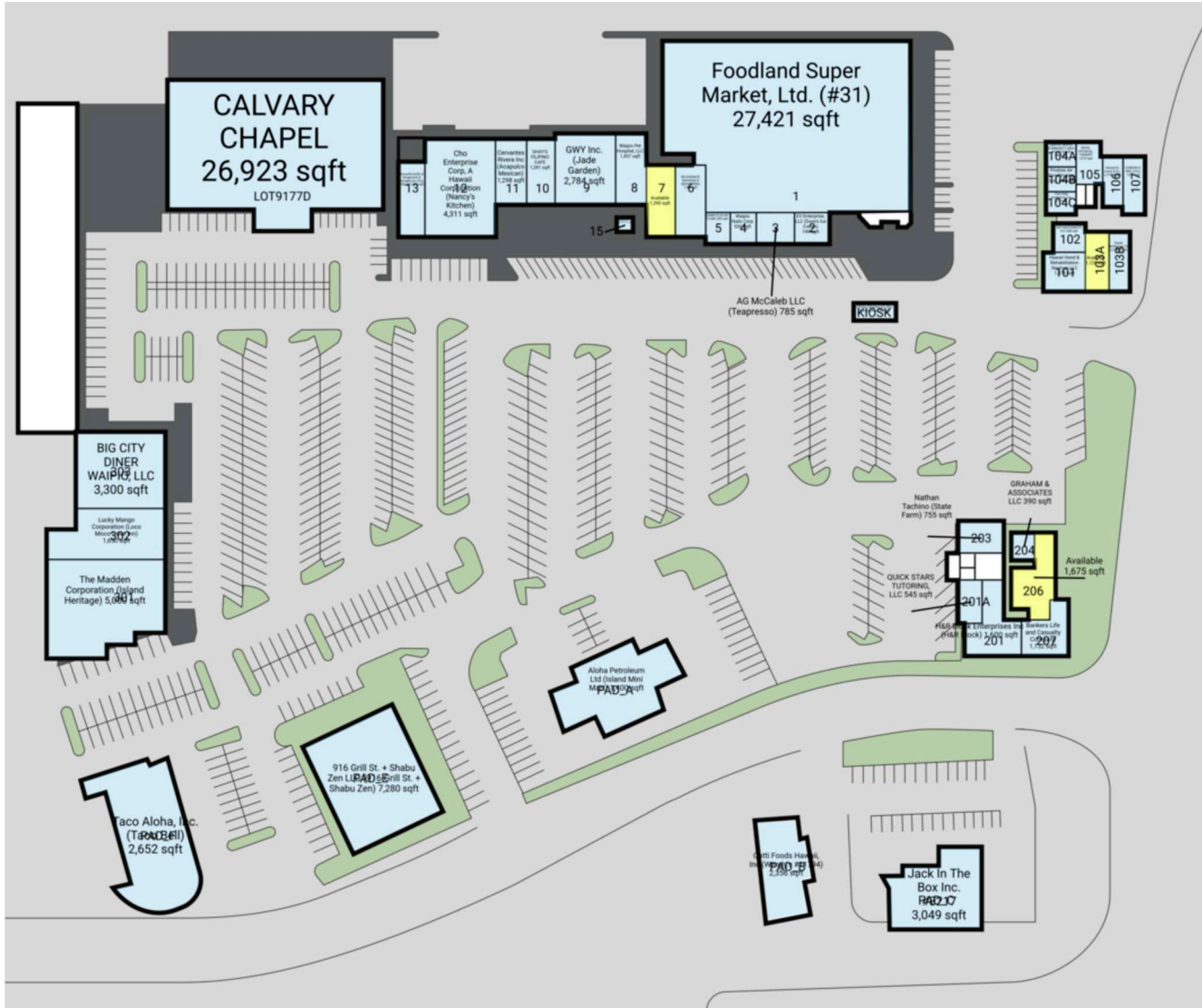

ALEXANDER & BALDWIN

822 Bishop Street, Honolulu, HI 96813 | www.alexanderbaldwin.com

Leasing: **Aja M. S. Shimamura (S)** (808) 525-6662 | ashimamura@abhi.com



WAIPIO SHOPPING CENTER

94-1040 Waipio Uka Street, Waipahu, HI, 96797

AVAILABLE SPACES

SPACE	SF	SPACE	SF
7	1,390 SF	206	1,675 SF
103A	1,128 SF		

All information is subject to change without notice. Dimensions, configurations, and frontages are approximate and any measurements are estimates. No promise is made that the spaces, common areas, amenities, landscaping, or features depicted are or will be built, or if built will be as shown. Landlord makes no representations about specific tenants or where they may operate. Unless Landlord signs a binding lease for a specific space, you do not have a right to lease any space. No content from these pages may be copied, republished, or distributed in any way without Landlord's written consent. Despite Landlord's efforts to provide accurate information, it is not possible to ensure it is always up to date, and Landlord assumes no responsibility for any actions taken in reliance on this information.



822 Bishop Street, Honolulu, HI 96813 | www.alexanderbaldwin.com

Leasing: **Aja M. S. Shimamura (S)** (808) 525-6662 | ashimamura@abhi.com

