

# KAHULUI OFFICE BUILDING

33 Lono Ave, Kahului, HI, 96732



## PROPERTY

Situated in central Kahului, this four-story Class 'A' office building caters to high quality tenants ranging from finance to medical services. Easy and accessible, Kahului Office Building has ample parking for tenants and visitors.

## CENTER SIZE

59,100 SF

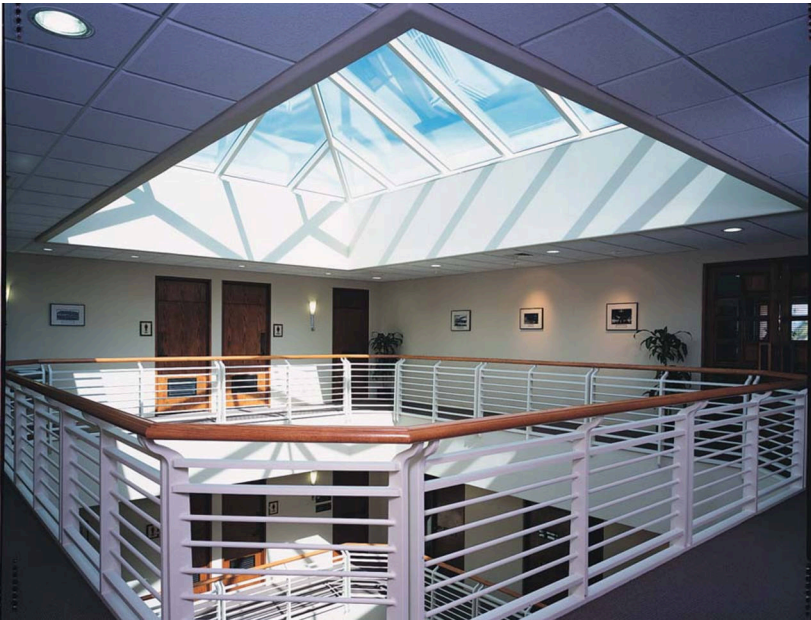

2024 DEMOGRAPHICS	1-Mile	3-Mile	5-Mile
Estimated Population	12,140	53,602	61,417
2021 Projected Population	12,140	53,602	61,417
Total Households	3,502	15,856	18,303
Average Household Income	\$100,370	\$118,169	\$121,254
Daytime Population	17,239	60,456	65,566
Median Age	40	41	41
Bachelor Degree or Higher	24%	28%	28%



ALEXANDER & BALDWIN

822 Bishop Street, Honolulu, HI 96813 | [www.alexanderbaldwin.com](http://www.alexanderbaldwin.com)

Leasing: **Cheyne K. Mench (S)** 808-525-8464 | [cmench@abhi.com](mailto:cmench@abhi.com)

Leasing: **Charles Buckingham (S)** (808) 870-1178 | [charles.buckingham@colliers.com](mailto:charles.buckingham@colliers.com)



# KAHULUI OFFICE BUILDING

33 Lono Ave, Kahului, HI, 96732

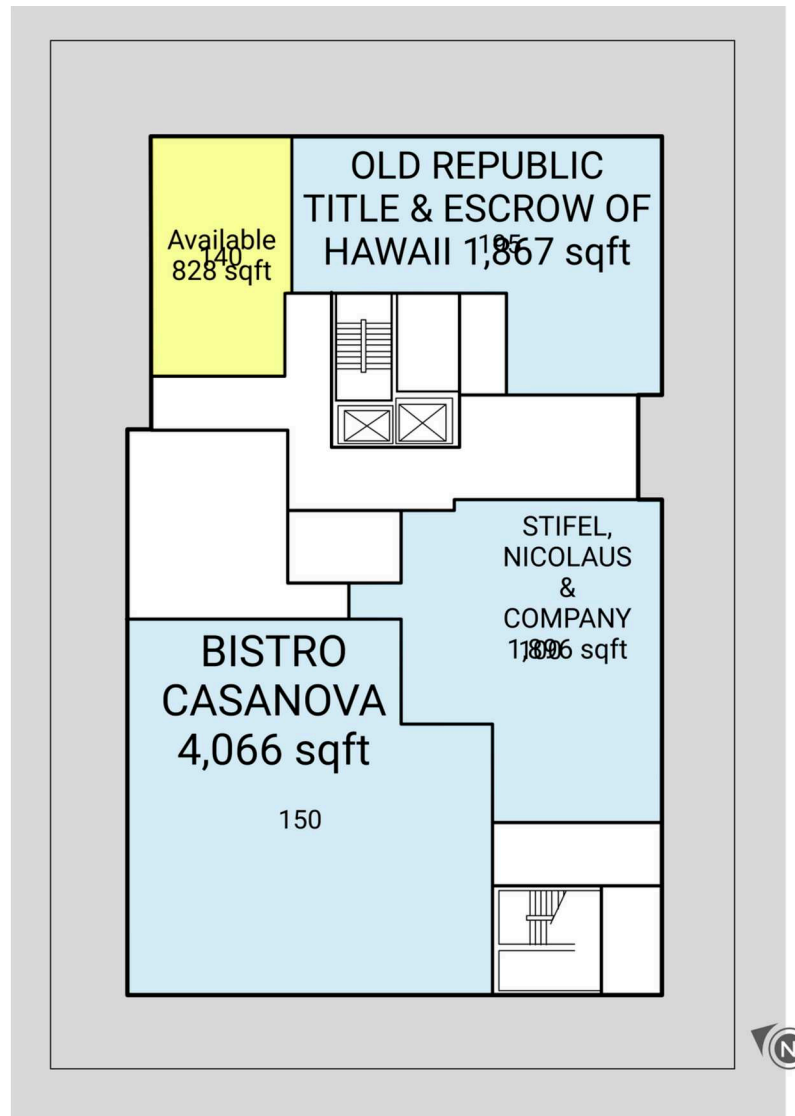

ALEXANDER & BALDWIN

822 Bishop Street, Honolulu, HI 96813 | [www.alexanderbaldwin.com](http://www.alexanderbaldwin.com)

Leasing: **Cheyne K. Mench (S)** 808-525-8464 | [cmench@abhi.com](mailto:cmench@abhi.com)

Leasing: **Charles Buckingham (S)** (808) 870-1178 | [charles.buckingham@colliers.com](mailto:charles.buckingham@colliers.com)



# KAHULUI OFFICE BUILDING

33 Lono Ave, Kahului, HI, 96732

## AVAILABLE SPACES

SPACE	SF
140	828 SF
220	740 SF
225	562 SF
230	525 SF
250	2,791 SF

SPACE	SF
270	793 SF
275	680 SF
280	1,045 SF
380	692 SF

All information is subject to change without notice. Dimensions, configurations, and frontages are approximate and any measurements are estimates. No promise is made that the spaces, common areas, amenities, landscaping, or features depicted are or will be built, or if built will be as shown. Landlord makes no representations about specific tenants or where they may operate. Unless Landlord signs a binding lease for a specific space, you do not have a right to lease any space. No content from these pages may be copied, republished, or distributed in any way without Landlord's written consent. Despite Landlord's efforts to provide accurate information, it is not possible to ensure it is always up to date, and Landlord assumes no responsibility for any actions taken in reliance on this information.



ALEXANDER & BALDWIN

822 Bishop Street, Honolulu, HI 96813 | [www.alexanderbaldwin.com](http://www.alexanderbaldwin.com)

Leasing: **Cheyne K. Mench (S)** 808-525-8464 | [cmench@abhi.com](mailto:cmench@abhi.com)

Leasing: **Charles Buckingham (S)** (808) 870-1178 | [charles.buckingham@colliers.com](mailto:charles.buckingham@colliers.com)



# KAHULUI OFFICE BUILDING

33 Lono Ave, Kahului, HI, 96732

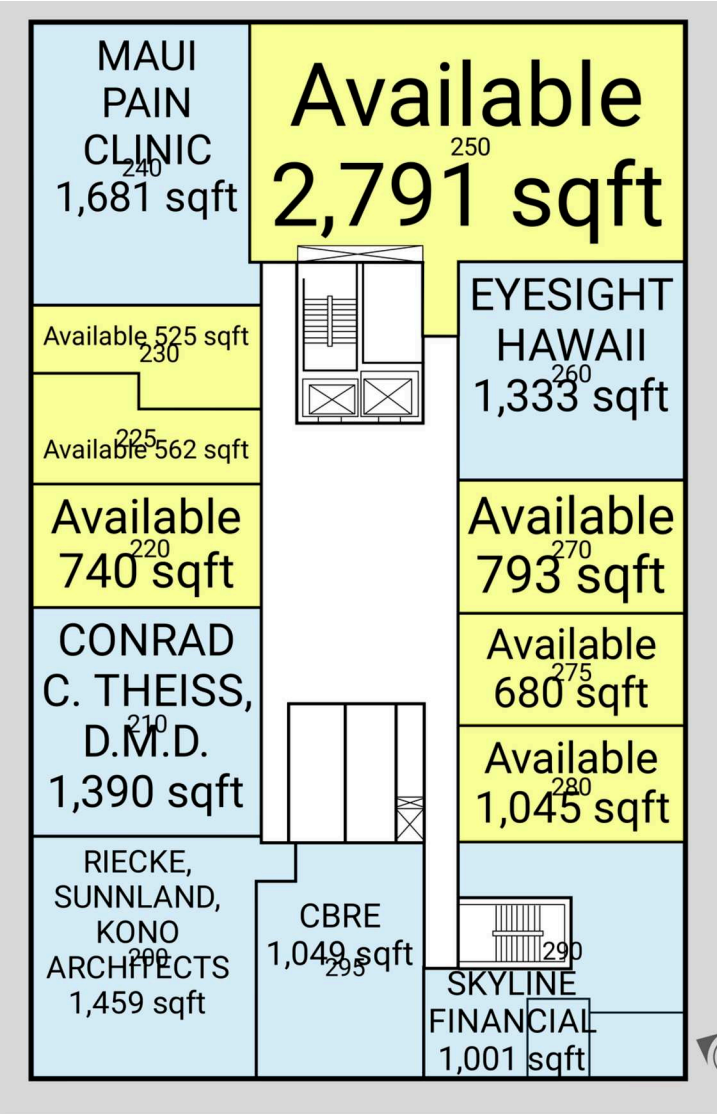

ALEXANDER & BALDWIN

822 Bishop Street, Honolulu, HI 96813 | [www.alexanderbaldwin.com](http://www.alexanderbaldwin.com)

Leasing: **Cheyne K. Mench (S)** 808-525-8464 | [cmench@abhi.com](mailto:cmench@abhi.com)

Leasing: **Charles Buckingham (S)** (808) 870-1178 | [charles.buckingham@colliers.com](mailto:charles.buckingham@colliers.com)





# KAHULUI OFFICE BUILDING

33 Lono Ave, Kahului, HI, 96732

## AVAILABLE SPACES

SPACE	SF
140	828 SF
220	740 SF
225	562 SF
230	525 SF
250	2,791 SF

SPACE	SF
270	793 SF
275	680 SF
280	1,045 SF
380	692 SF

All information is subject to change without notice. Dimensions, configurations, and frontages are approximate and any measurements are estimates. No promise is made that the spaces, common areas, amenities, landscaping, or features depicted are or will be built, or if built will be as shown. Landlord makes no representations about specific tenants or where they may operate. Unless Landlord signs a binding lease for a specific space, you do not have a right to lease any space. No content from these pages may be copied, republished, or distributed in any way without Landlord's written consent. Despite Landlord's efforts to provide accurate information, it is not possible to ensure it is always up to date, and Landlord assumes no responsibility for any actions taken in reliance on this information.



ALEXANDER & BALDWIN

822 Bishop Street, Honolulu, HI 96813 | [www.alexanderbaldwin.com](http://www.alexanderbaldwin.com)

Leasing: **Cheyne K. Mench (S)** 808-525-8464 | [cmench@abhi.com](mailto:cmench@abhi.com)

Leasing: **Charles Buckingham (S)** (808) 870-1178 | [charles.buckingham@colliers.com](mailto:charles.buckingham@colliers.com)



# KAHULUI OFFICE BUILDING

33 Lono Ave, Kahului, HI, 96732

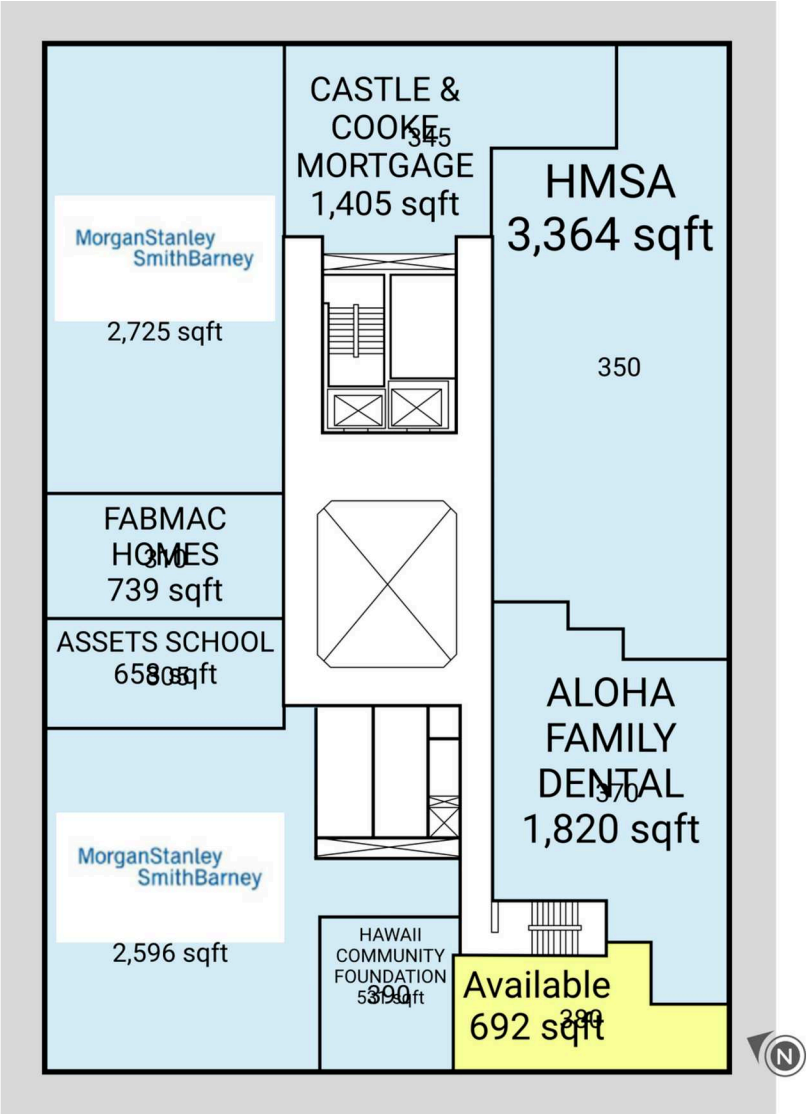

ALEXANDER & BALDWIN

822 Bishop Street, Honolulu, HI 96813 | [www.alexanderbaldwin.com](http://www.alexanderbaldwin.com)

Leasing: **Cheyne K. Mench (S)** 808-525-8464 | [cmench@abhi.com](mailto:cmench@abhi.com)

Leasing: **Charles Buckingham (S)** (808) 870-1178 | [charles.buckingham@colliers.com](mailto:charles.buckingham@colliers.com)



# KAHULUI OFFICE BUILDING

33 Lono Ave, Kahului, HI, 96732

## AVAILABLE SPACES

SPACE	SF
140	828 SF
220	740 SF
225	562 SF
230	525 SF
250	2,791 SF

SPACE	SF
270	793 SF
275	680 SF
280	1,045 SF
380	692 SF

All information is subject to change without notice. Dimensions, configurations, and frontages are approximate and any measurements are estimates. No promise is made that the spaces, common areas, amenities, landscaping, or features depicted are or will be built, or if built will be as shown. Landlord makes no representations about specific tenants or where they may operate. Unless Landlord signs a binding lease for a specific space, you do not have a right to lease any space. No content from these pages may be copied, republished, or distributed in any way without Landlord's written consent. Despite Landlord's efforts to provide accurate information, it is not possible to ensure it is always up to date, and Landlord assumes no responsibility for any actions taken in reliance on this information.



ALEXANDER & BALDWIN

822 Bishop Street, Honolulu, HI 96813 | [www.alexanderbaldwin.com](http://www.alexanderbaldwin.com)

Leasing: **Cheyne K. Mench (S)** 808-525-8464 | [cmench@abhi.com](mailto:cmench@abhi.com)

Leasing: **Charles Buckingham (S)** (808) 870-1178 | [charles.buckingham@colliers.com](mailto:charles.buckingham@colliers.com)



# KAHULUI OFFICE BUILDING

33 Lono Ave, Kahului, HI, 96732

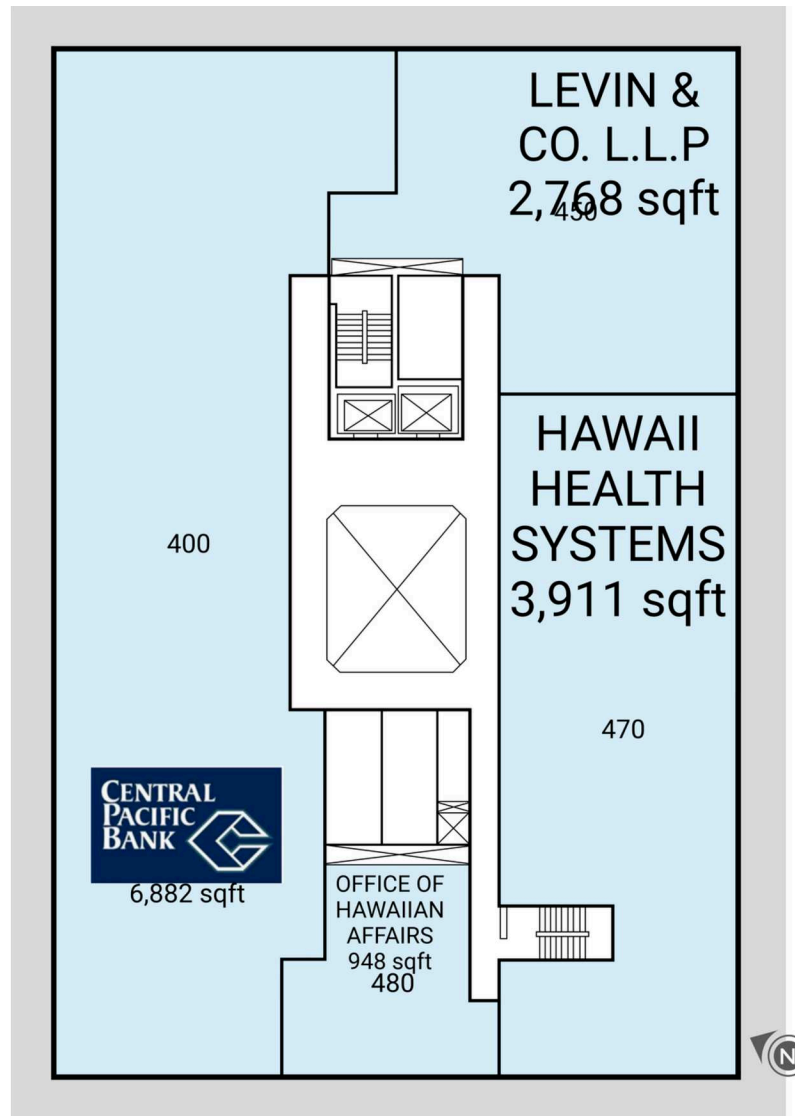

ALEXANDER & BALDWIN

822 Bishop Street, Honolulu, HI 96813 | [www.alexanderbaldwin.com](http://www.alexanderbaldwin.com)

Leasing: **Cheyne K. Mench (S)** 808-525-8464 | [cmench@abhi.com](mailto:cmench@abhi.com)

Leasing: **Charles Buckingham (S)** (808) 870-1178 | [charles.buckingham@colliers.com](mailto:charles.buckingham@colliers.com)





# KAHULUI OFFICE BUILDING

33 Lono Ave, Kahului, HI, 96732

## AVAILABLE SPACES

SPACE	SF
140	828 SF
220	740 SF
225	562 SF
230	525 SF
250	2,791 SF

SPACE	SF
270	793 SF
275	680 SF
280	1,045 SF
380	692 SF

All information is subject to change without notice. Dimensions, configurations, and frontages are approximate and any measurements are estimates. No promise is made that the spaces, common areas, amenities, landscaping, or features depicted are or will be built, or if built will be as shown. Landlord makes no representations about specific tenants or where they may operate. Unless Landlord signs a binding lease for a specific space, you do not have a right to lease any space. No content from these pages may be copied, republished, or distributed in any way without Landlord's written consent. Despite Landlord's efforts to provide accurate information, it is not possible to ensure it is always up to date, and Landlord assumes no responsibility for any actions taken in reliance on this information.



ALEXANDER & BALDWIN

822 Bishop Street, Honolulu, HI 96813 | [www.alexanderbaldwin.com](http://www.alexanderbaldwin.com)

Leasing: **Cheyne K. Mench (S)** 808-525-8464 | [cmench@abhi.com](mailto:cmench@abhi.com)

Leasing: **Charles Buckingham (S)** (808) 870-1178 | [charles.buckingham@colliers.com](mailto:charles.buckingham@colliers.com)

