

KAKAAKO COMMERCE CENTER

850 Kawaiahao Street, Honolulu, HI, 96813



PROPERTY

Industrial center located in urban Honolulu in Kakaako off the Kapiolani corridor. Kakaako Commerce Center is less than 1 mile from downtown Honolulu, Ala Moana and Ward Centers and 2 miles from Waikiki. The industrial center is easily accessible from major thoroughfares with convenient loading docks for large containers. A photovoltaic system of nearly 1,000 solar panels began delivering renewable energy to the industrial center at the close of 2023.

CENTER SIZE

197,900 SF

2024 DEMOGRAPHICS

	1-Mile	3-Mile	5-Mile
Estimated Population	47,524	215,622	329,134
2021 Projected Population	47,524	215,622	329,134
Total Households	24,345	93,227	131,223
Average Household Income	\$108,824	\$106,258	\$118,552
Daytime Population	137,642	343,376	465,011
Median Age	45	45	44
Bachelor Degree or Higher	49%	41%	42%



ALEXANDER & BALDWIN

822 Bishop Street, Honolulu, HI 96813 | www.alexanderbaldwin.com

Leasing: **Cheyne K. Mench (S)** 808-525-8464 | cmench@abhi.com



KAKAAKO COMMERCE CENTER

850 Kawaihāo Street, Honolulu, HI, 96813

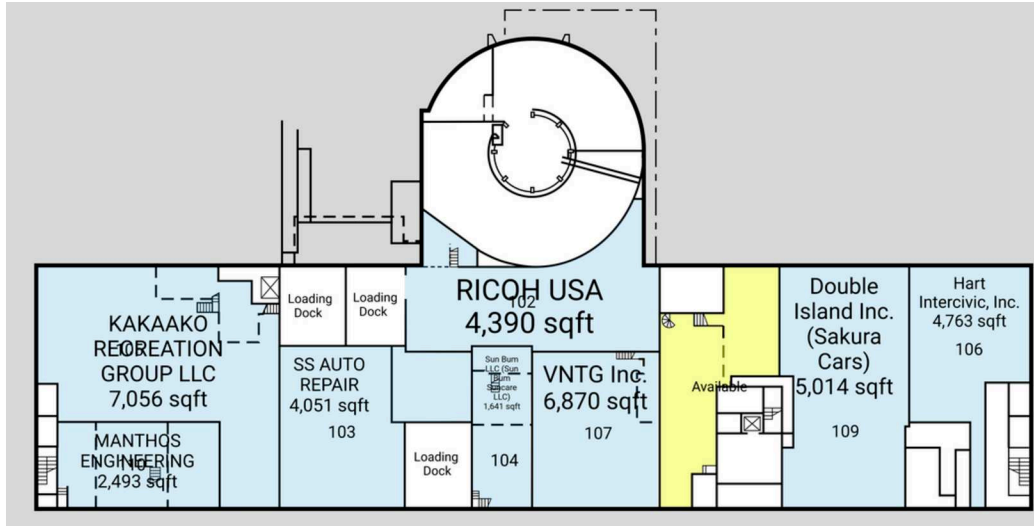

Floor 1

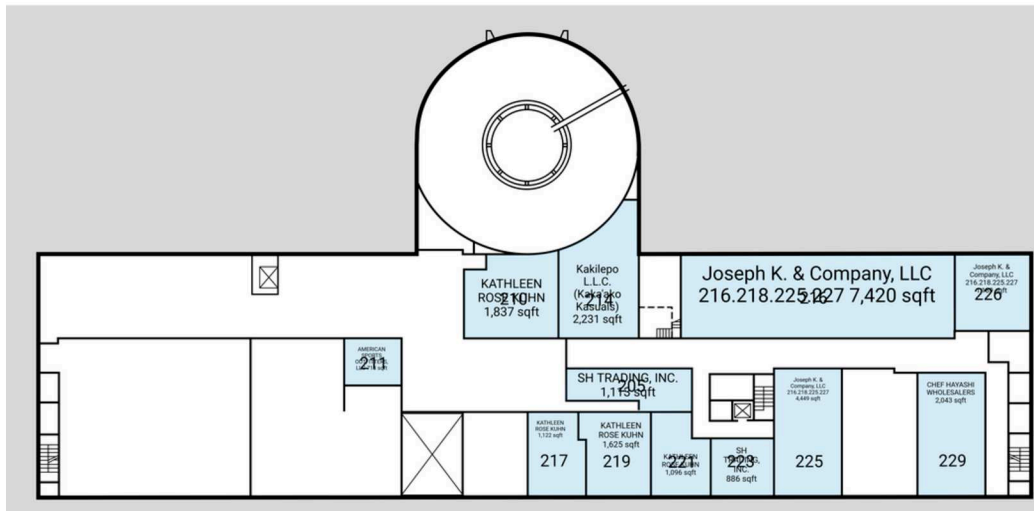

Floor 2



ALEXANDER & BALDWIN

822 Bishop Street, Honolulu, HI 96813 | www.alexanderbaldwin.com

Leasing: **Cheyne K. Mench (S)** 808-525-8464 | cmench@abhi.com



KAKAAKO COMMERCE CENTER

850 Kawaiahao Street, Honolulu, HI, 96813

AVAILABLE SPACES

SPACE	SF
108	-

All information is subject to change without notice. Dimensions, configurations, and frontages are approximate and any measurements are estimates. No promise is made that the spaces, common areas, amenities, landscaping, or features depicted are or will be built, or if built will be as shown. Landlord makes no representations about specific tenants or where they may operate. Unless Landlord signs a binding lease for a specific space, you do not have a right to lease any space. No content from these pages may be copied, republished, or distributed in any way without Landlord's written consent. Despite Landlord's efforts to provide accurate information, it is not possible to ensure it is always up to date, and Landlord assumes no responsibility for any actions taken in reliance on this information.



ALEXANDER & BALDWIN

822 Bishop Street, Honolulu, HI 96813 | www.alexanderbaldwin.com

Leasing: **Cheyne K. Mench (S)** 808-525-8464 | cmench@abhi.com



KAKAAKO COMMERCE CENTER

850 Kawaihāo Street, Honolulu, HI, 96813

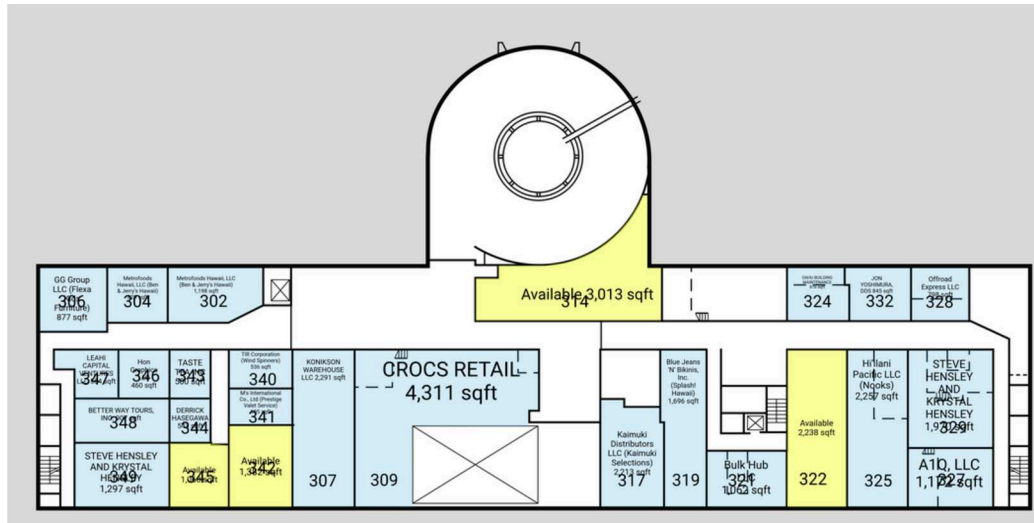

Floor 3

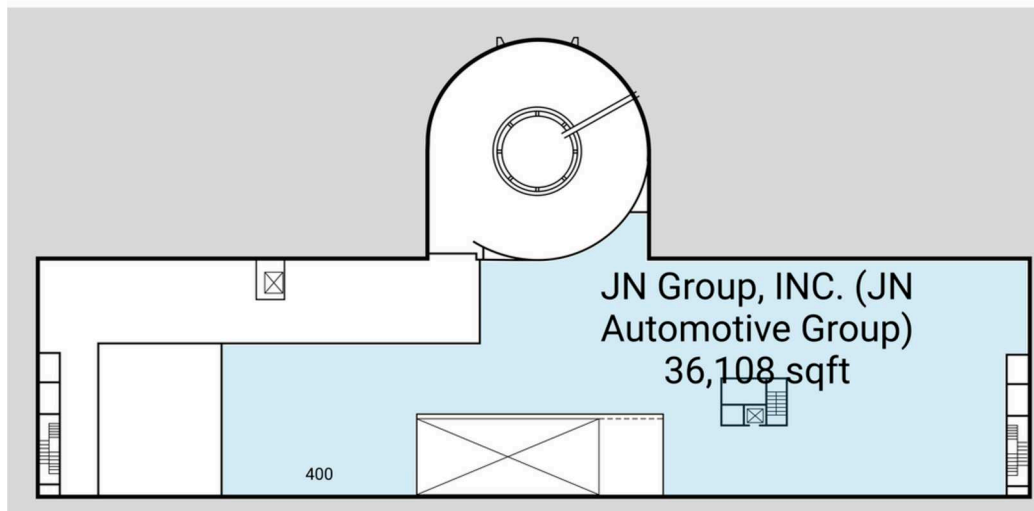

Floor 4



ALEXANDER & BALDWIN

822 Bishop Street, Honolulu, HI 96813 | www.alexanderbaldwin.com

Leasing: **Cheyne K. Mench (S)** 808-525-8464 | cmench@abhi.com



KAKAAKO COMMERCE CENTER

850 Kawaiahao Street, Honolulu, HI, 96813

AVAILABLE SPACES

SPACE	SF	SPACE	SF
314	3,013 SF	342	1,382 SF
322	2,238 SF	345	1,068 SF

All information is subject to change without notice. Dimensions, configurations, and frontages are approximate and any measurements are estimates. No promise is made that the spaces, common areas, amenities, landscaping, or features depicted are or will be built, or if built will be as shown. Landlord makes no representations about specific tenants or where they may operate. Unless Landlord signs a binding lease for a specific space, you do not have a right to lease any space. No content from these pages may be copied, republished, or distributed in any way without Landlord's written consent. Despite Landlord's efforts to provide accurate information, it is not possible to ensure it is always up to date, and Landlord assumes no responsibility for any actions taken in reliance on this information.



ALEXANDER & BALDWIN

822 Bishop Street, Honolulu, HI 96813 | www.alexanderbaldwin.com

Leasing: **Cheyne K. Mench (S)** 808-525-8464 | cmench@abhi.com



KAKAAKO COMMERCE CENTER

850 Kawaiahao Street, Honolulu, HI, 96813

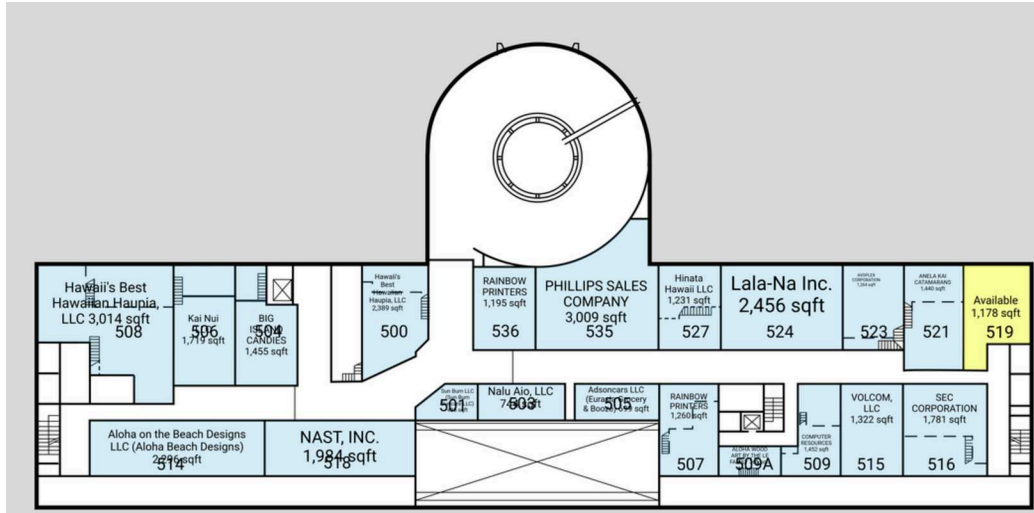

Floor 5

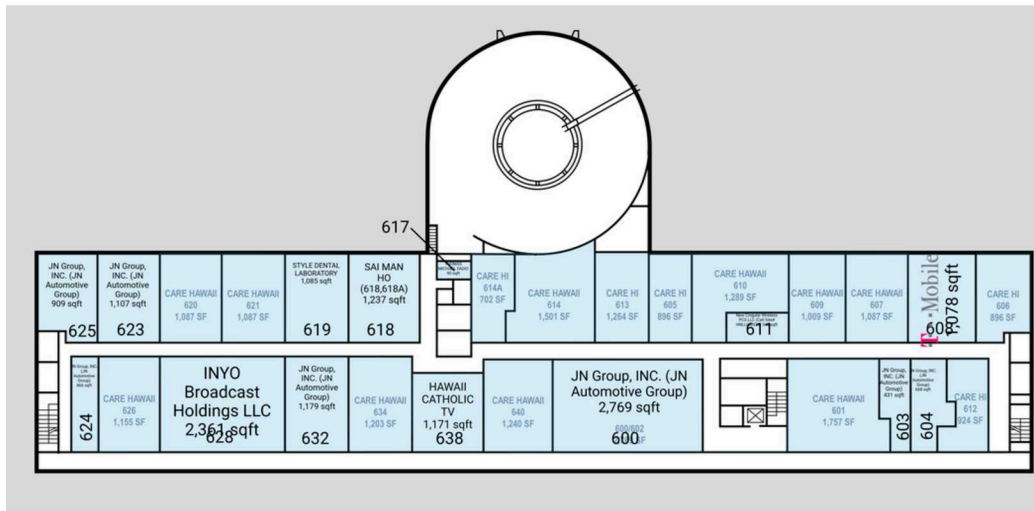

Floor 6



ALEXANDER & BALDWIN

822 Bishop Street, Honolulu, HI 96813 | www.alexanderbaldwin.com

Leasing: **Cheyne K. Mench (S)** 808-525-8464 | cmench@abhi.com



KAKAAKO COMMERCE CENTER

850 Kawaiahao Street, Honolulu, HI, 96813

AVAILABLE SPACES

SPACE	SF
519	1,178 SF

All information is subject to change without notice. Dimensions, configurations, and frontages are approximate and any measurements are estimates. No promise is made that the spaces, common areas, amenities, landscaping, or features depicted are or will be built, or if built will be as shown. Landlord makes no representations about specific tenants or where they may operate. Unless Landlord signs a binding lease for a specific space, you do not have a right to lease any space. No content from these pages may be copied, republished, or distributed in any way without Landlord's written consent. Despite Landlord's efforts to provide accurate information, it is not possible to ensure it is always up to date, and Landlord assumes no responsibility for any actions taken in reliance on this information.



ALEXANDER & BALDWIN

822 Bishop Street, Honolulu, HI 96813 | www.alexanderbaldwin.com

Leasing: **Cheyne K. Mench (S)** 808-525-8464 | cmench@abhi.com



KAKAAKO COMMERCE CENTER

850 Kawaiahao Street, Honolulu, HI, 96813



ALEXANDER & BALDWIN

822 Bishop Street, Honolulu, HI 96813 | www.alexanderbaldwin.com

Leasing: **Cheyne K. Mench (S)** 808-525-8464 | cmench@abhi.com



KAKAAKO COMMERCE CENTER

850 Kawaiahao Street, Honolulu, HI, 96813

AVAILABLE SPACES

SPACE	SF
No Availabilities	

All information is subject to change without notice. Dimensions, configurations, and frontages are approximate and any measurements are estimates. No promise is made that the spaces, common areas, amenities, landscaping, or features depicted are or will be built, or if built will be as shown. Landlord makes no representations about specific tenants or where they may operate. Unless Landlord signs a binding lease for a specific space, you do not have a right to lease any space. No content from these pages may be copied, republished, or distributed in any way without Landlord's written consent. Despite Landlord's efforts to provide accurate information, it is not possible to ensure it is always up to date, and Landlord assumes no responsibility for any actions taken in reliance on this information.

